



712/912 TRENCHER CHAIN TYPES / DESCRIPTIONS

STANDARD CUP CHAIN (AKA Skip Tooth)

This chain has a cup tooth on every other link.

Where to use it

This chain is most effective in loamy soil - soil that is packable into clods. It is also more effective in clay or "gumbo" soil that is sticky and clings to the chain. The space between the cups allows the soil to let go instead of running around with the chain as a slurry which prevents effective digging.



DOUBLE CUP CHAIN

This chain has a cup tooth on every link.

Where to use it

This chain is best for sand and dry, loose soil that has a tendency to fall back into the trench. The extra cups provide for better clean-out.



COMBO/SHARK CHAIN

This chain has an alternating pattern of cup and Shark teeth.

Where to use it.

It is designed for areas that have variable soil types. The shark teeth are effective in rocky soil or hard-pan while the cups provide for efficient clean-out. This is our most popular chain.



SHARK CHAIN

The teeth on this chain are all Shark teeth that are welded onto the chain. Replacement teeth are not available for this chain.

Where to use it.

This chain can be used in the most adverse soils. It is good in rocky soil, "cliché", limestone, hard-pan and any other hard to dig soils. It does not clean out well in sandy or dry, loose, loamy soil. This is not the fastest but it is the most durable chain available. It is not uncommon for the teeth to outlast the chain rollers. When the rollers wear out, the complete chain must be replaced.



BOLT-ON SHARK CHAIN

This chain utilizes a standard chain blank and has Shark teeth that are bolted to the chain blank.

Where to use it.

This chain is good in all the conditions described for the Shark chain. The advantage is the teeth can be removed when the chain wears out and can be used on a new blank. It is not uncommon for the teeth to last through two chains.



NOTE: The 712 trencher chains are available in 12" & 18" lengths and 4" & 5" widths. The 912 chains are available in 12", 18", & 24" lengths and 4" & 6" widths.

ITEM NO.	PART NUMBER	DESCRIPTION	QTY.
1	03622-B	BARE CHAIN, 22 STATION, 1.25 PITCH	1
2	03519	CONNECTING PIN (COTTER INCLUDED)	1

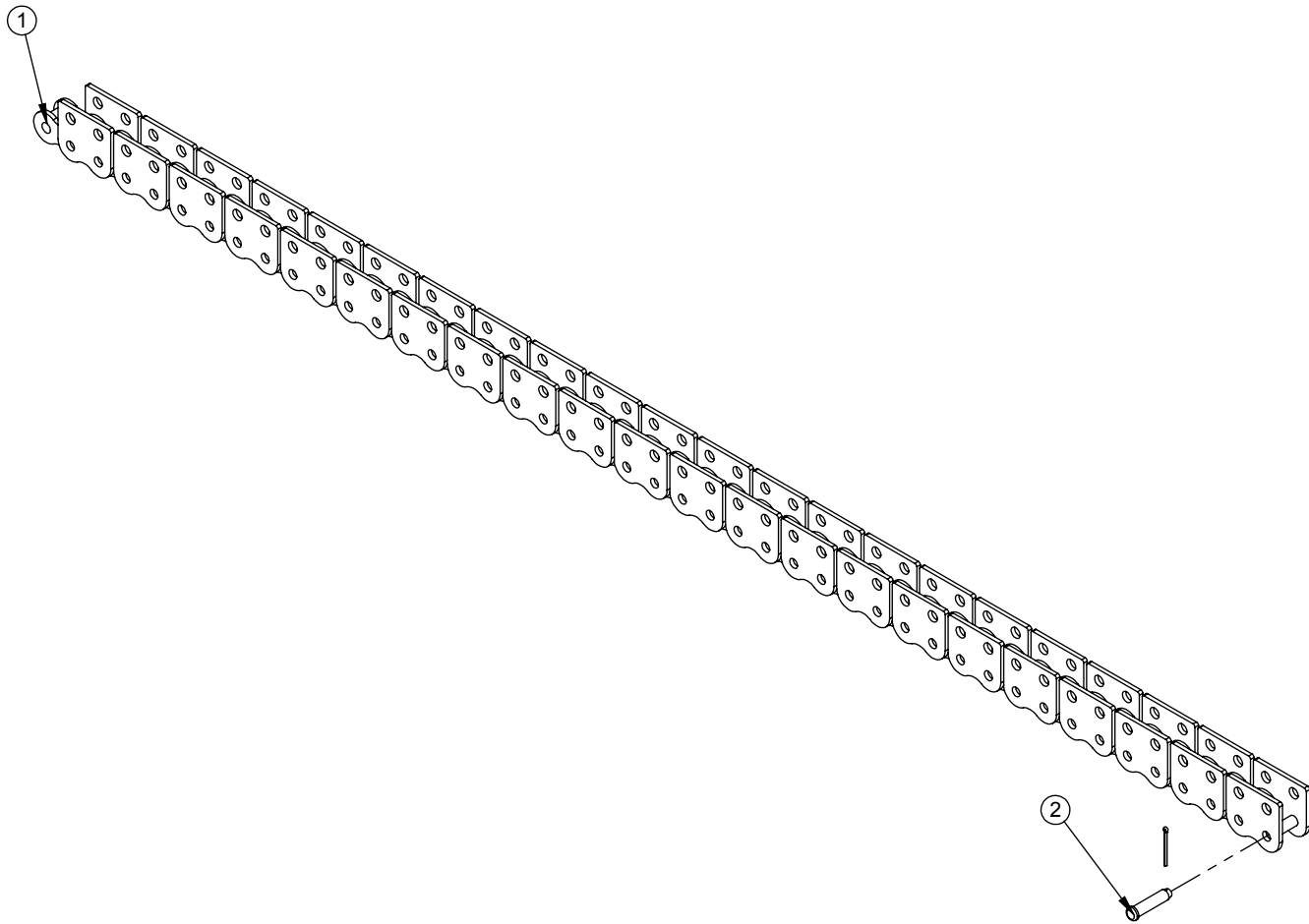

ESTIMATED SHIPPING WEIGHT: 35LBS

BARRETO	TITLE: BARE CHAIN, 44 LINK, 1.25 PITCH	
	PRODUCT LINE: TRENCHERS 912, 712 DATE: 03/20/2014	
	SCALE: 1:6 SHEET 1 OF 1	DWG# 03622-B

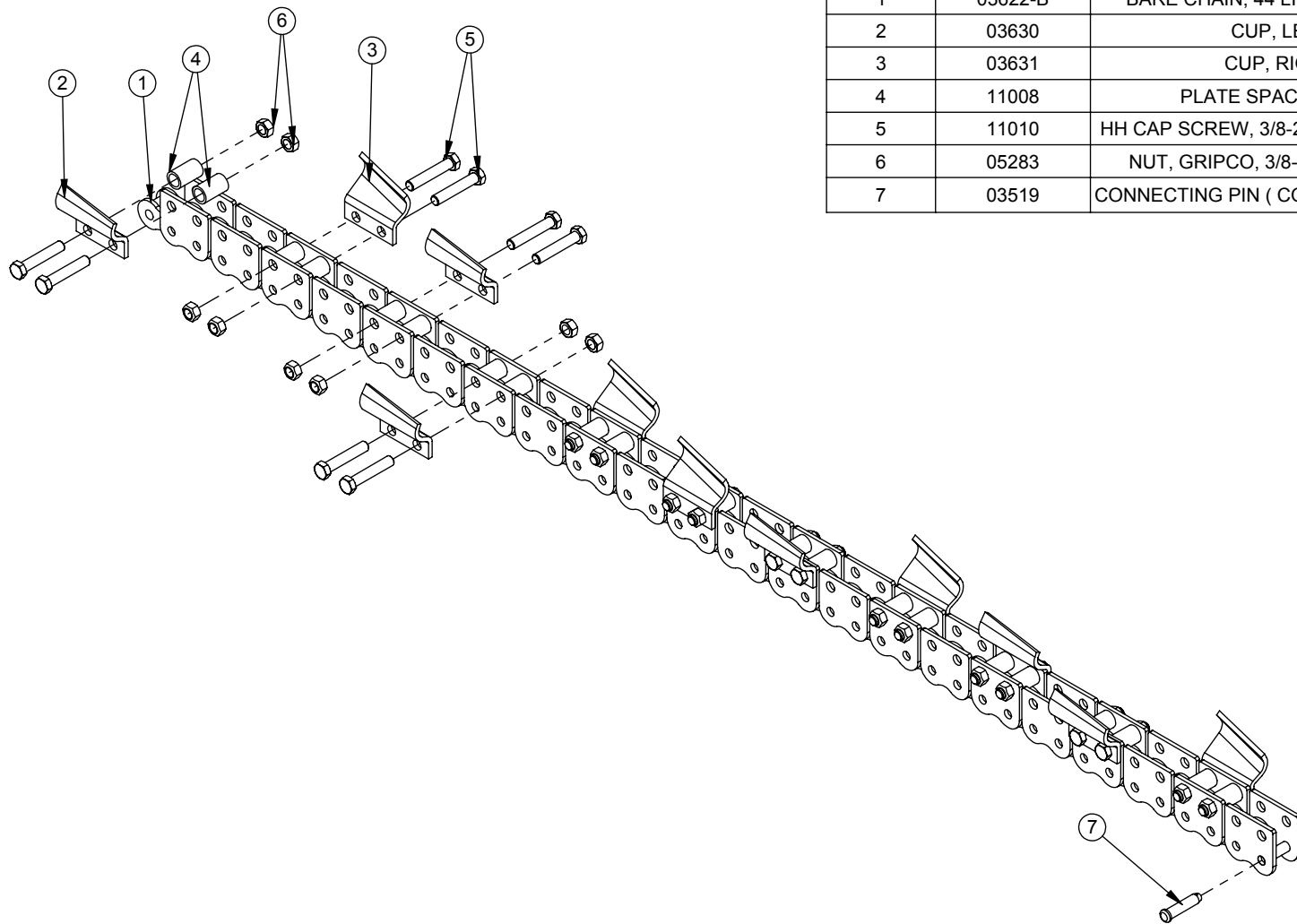

ITEM NO.	PART NUMBER	DESCRIPTION	QTY.
1	03622-B	BARE CHAIN, 44 LINK, 1.25 PITCH	1
2	03630	CUP, LEFT	6
3	03631	CUP, RIGHT	5
4	11008	PLATE SPACER, 1.06"	22
5	11010	HH CAP SCREW, 3/8-24 NF X 2 G8 ZINC	22
6	05283	NUT, GRIPCO, 3/8-24 NF G8 ZINC	22
7	03519	CONNECTING PIN (COTTER INCLUDED)	1

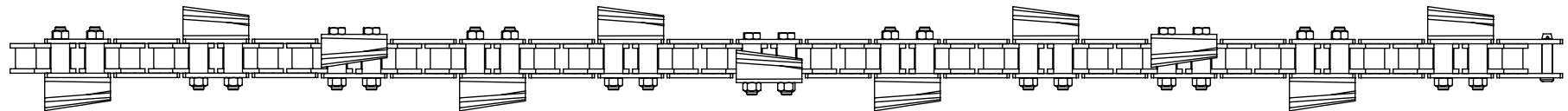

ESTIMATED SHIPPING WEIGHT: 40 LBS

BARRETO

TITLE: CHAIN, 12" 11 STA 4" CUP
 PRODUCT LINE: TRENCHERS 912, 712 DATE: 03/18/2014
 SCALE: 1:6
 SHEET 1 OF 1 DWG# 03611-4C

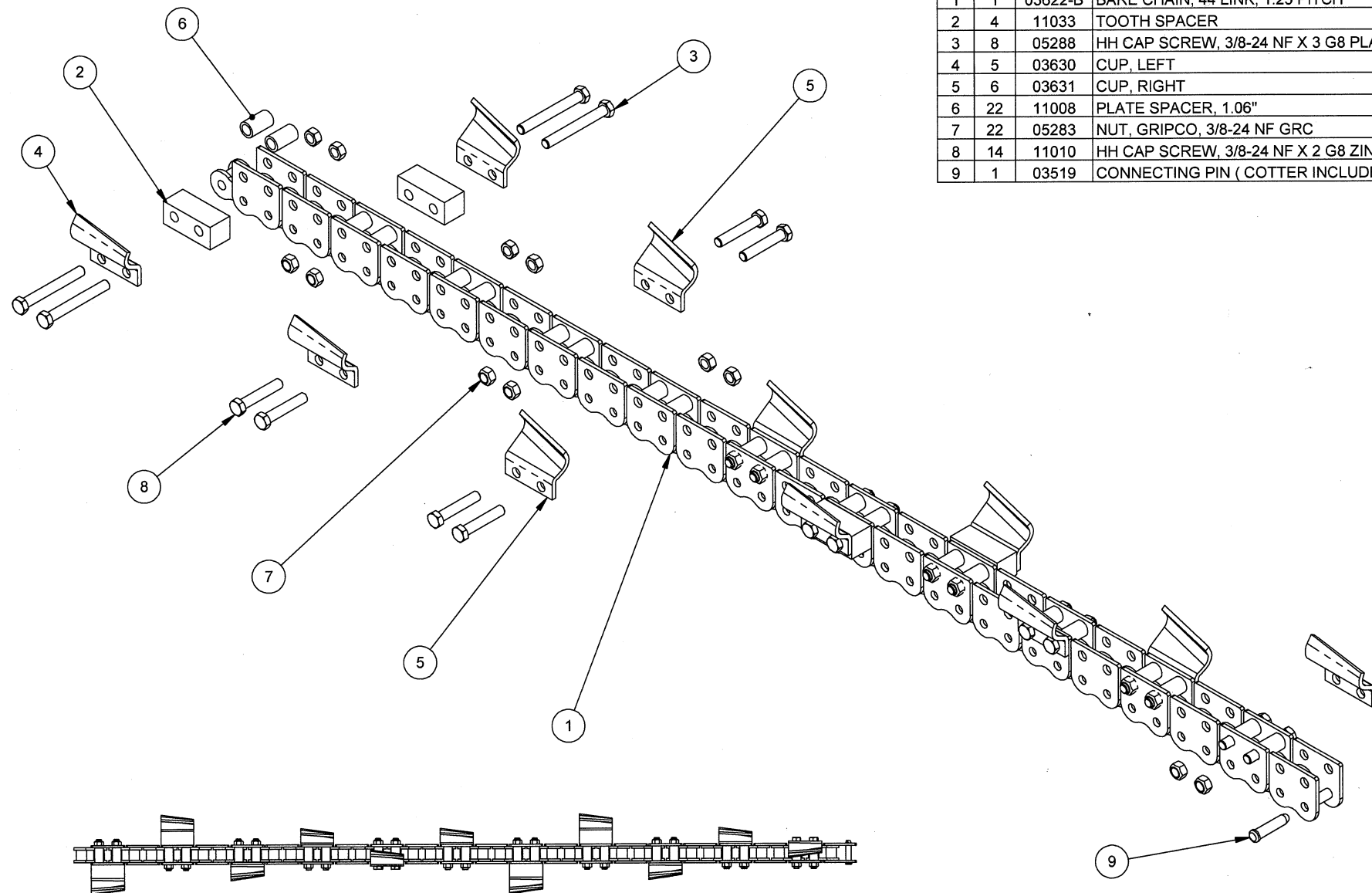

REF.	QTY.	PART NO.	DESCRIPTION
1	1	03622-B	BARE CHAIN, 44 LINK, 1.25 PITCH
2	4	11033	TOOTH SPACER
3	8	05288	HH CAP SCREW, 3/8-24 NF X 3 G8 PLAIN
4	5	03630	CUP, LEFT
5	6	03631	CUP, RIGHT
6	22	11008	PLATE SPACER, 1.06"
7	22	05283	NUT, GRIPCO, 3/8-24 NF GRC
8	14	11010	HH CAP SCREW, 3/8-24 NF X 2 G8 ZINC
9	1	03519	CONNECTING PIN (COTTER INCLUDED)

BARRETO

TITLE: CUP CHAIN, 6 X 12" CUT
44 LINK, 11 STATION

PRODUCT LINE: TRENCHER 912

DATE: 2/06

SCALE: 1:5

DWG# 03611-6C

SHEET 1 OF 1

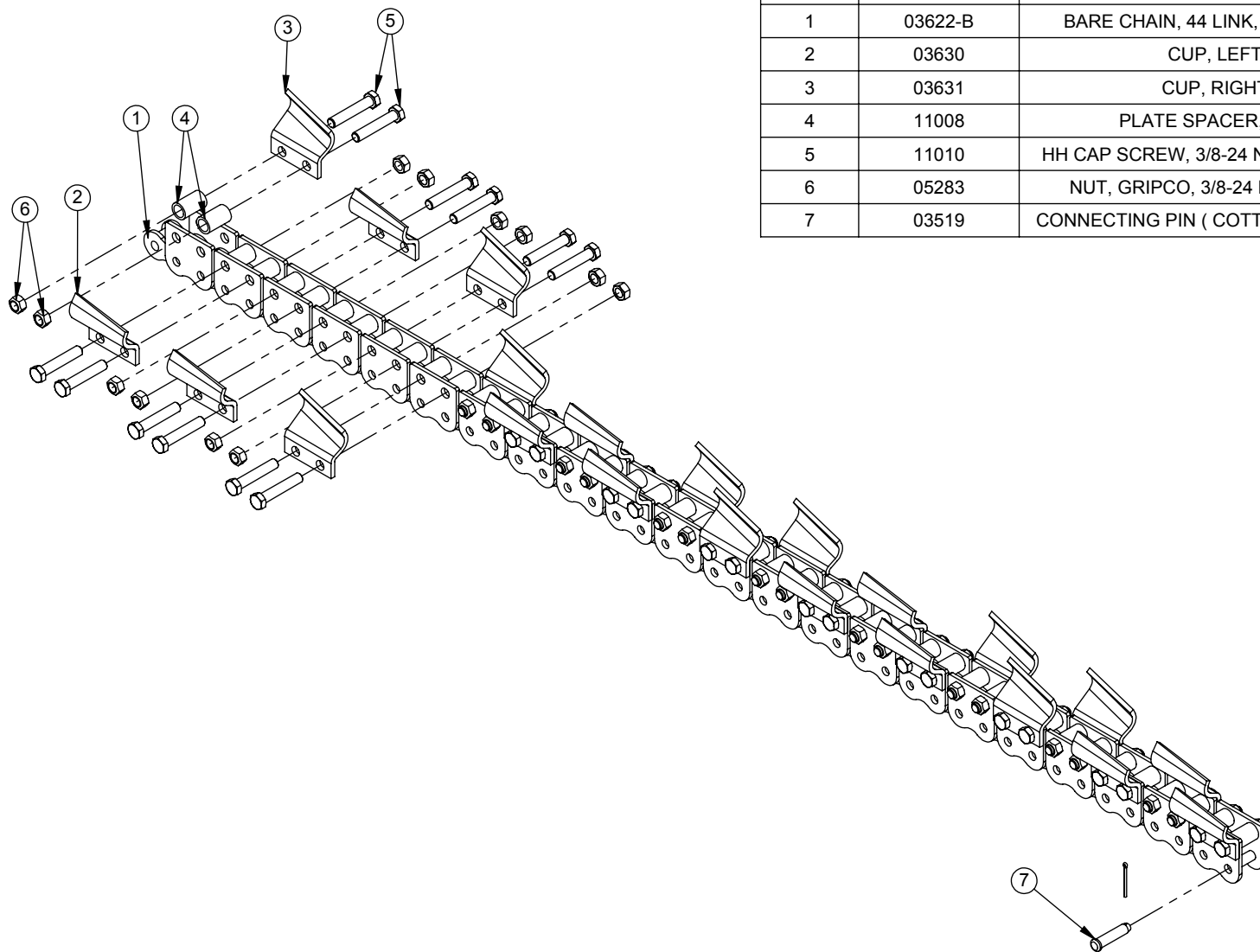

ITEM NO.	PART NUMBER	DESCRIPTION	QTY.
1	03622-B	BARE CHAIN, 44 LINK, 1.25" PITCH	1
2	03630	CUP, LEFT	12
3	03631	CUP, RIGHT	10
4	11008	PLATE SPACER, 1.06"	44
5	11010	HH CAP SCREW, 3/8-24 NF X 2 G8 ZINC	44
6	05283	NUT, GRIPCO, 3/8-24 NF G8 ZINC	44
7	03519	CONNECTING PIN (COTTER INCLUDED)	1

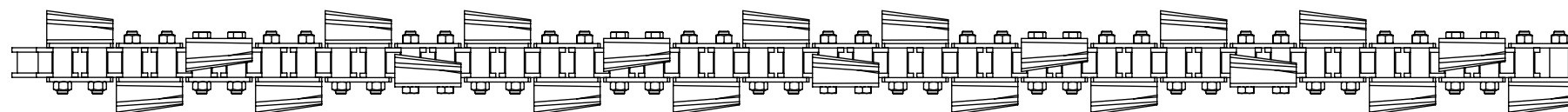

ESTIMATED SHIPPING WEIGHT: 40 LBS

BARRETO

TITLE: CHAIN, 12" 22 STA 4" CUP

PRODUCT LINE: TRENCHERS 912, 712 DATE: 04/11/2014

SCALE: 1:6

DWG# 03622-4C

SHEET 1 OF 1

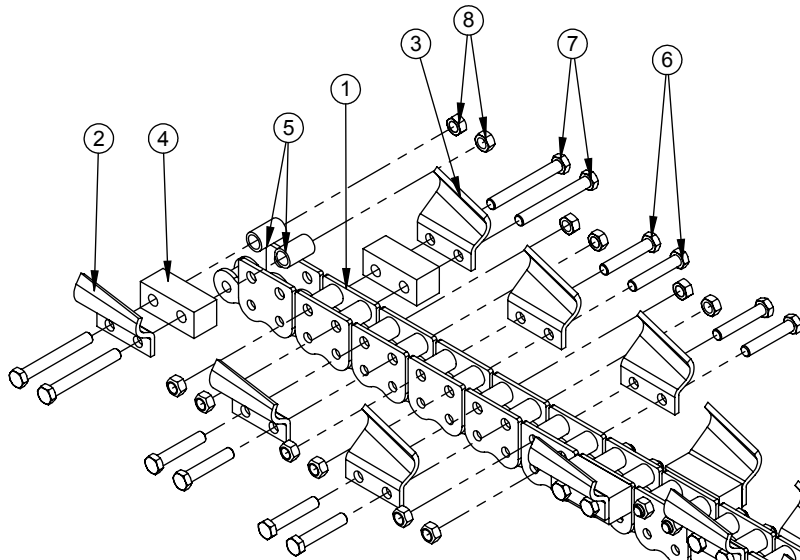

ITEM NO.	PART NUMBER	DESCRIPTION	QTY.
1	03622-B	BARE CHAIN, 44 LINK, 1.25 PITCH	1
2	03630	CUP, LEFT	10
3	03631	CUP, RIGHT	12
4	11033	TOOTH SPACER	8
5	11008	PLATE SPACER, 1.06"	44
6	11010	HH CAP SCREW, 3/8-24 NF X 2 G8 ZINC	28
7	05288	HH CAP SCREW, 3/8-24 NF X 3 G8 ZINC	16
8	05283	NUT, GRIPCO, 3/8-24 NF G8 ZINC	44
9	03519	CONNECTING PIN (COTTER INCLUDED)	1

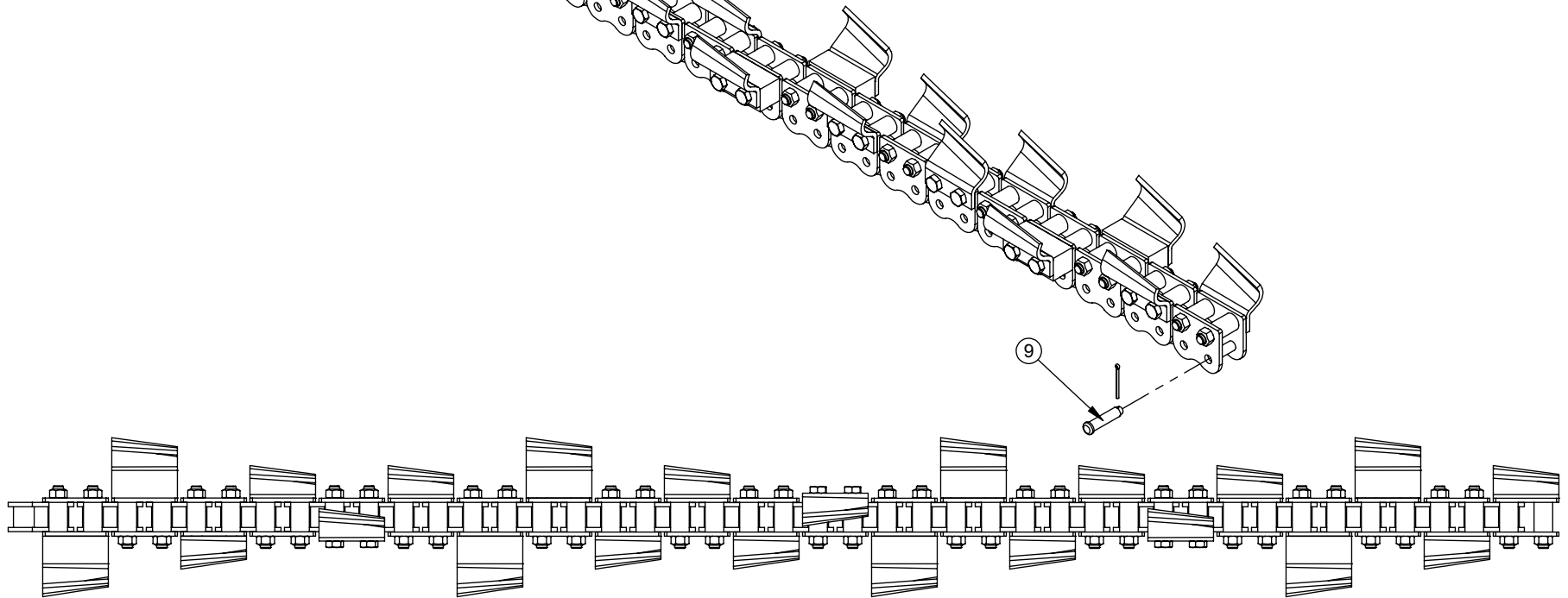

ESTIMATED SHIPPING WEIGHT: 55 LBS

BARRETO

TITLE: CHAIN, 12" 22 STA 6" CUP

PRODUCT LINE: TRENCHERS 912, 712 DATE: 03/18/2014

SCALE: 1:6
SHEET 1 OF 1

DWG# 03622-6C

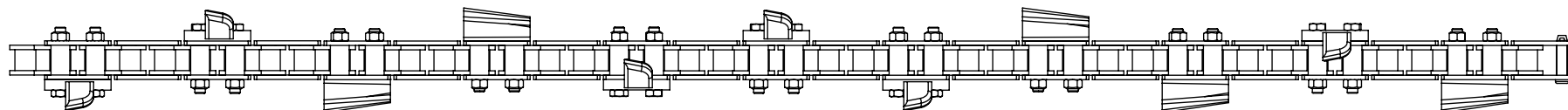
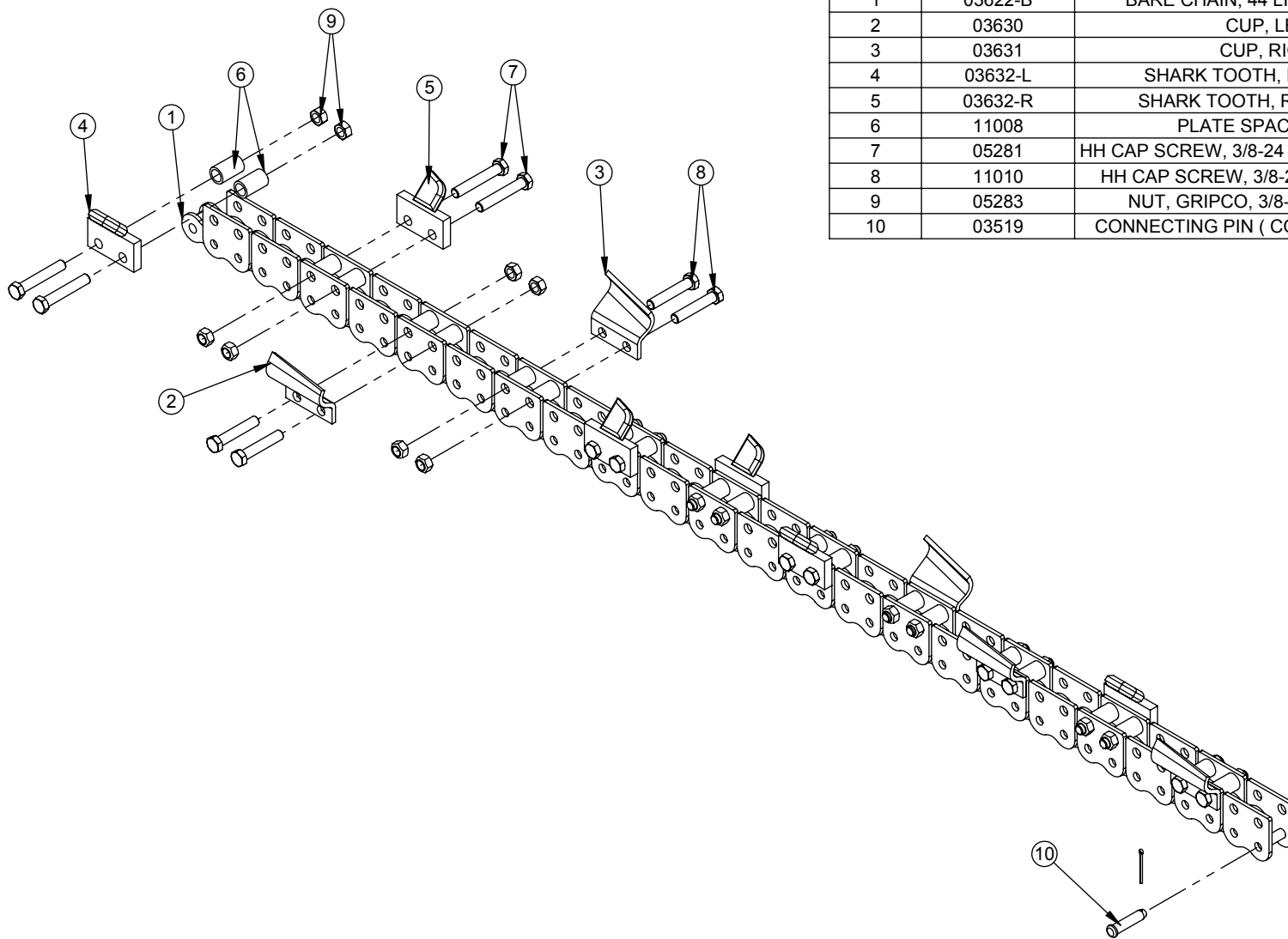

ITEM NO.	PART NUMBER	DESCRIPTION	QTY.
1	03622-B	BARE CHAIN, 44 LINK, 1.25 PITCH	1
2	03630	CUP, LEFT	3
3	03631	CUP, RIGHT	2
4	03632-L	SHARK TOOTH, LEFT, 1.25" P	3
5	03632-R	SHARK TOOTH, RIGHT, 1.25" P	3
6	11008	PLATE SPACER, 1.06"	22
7	05281	HH CAP SCREW, 3/8-24 NF X 2-1/4 G8 PLAIN	12
8	11010	HH CAP SCREW, 3/8-24 NF X 2 G8 ZINC	10
9	05283	NUT, GRIPCO, 3/8-24 NF G8 ZINC	22
10	03519	CONNECTING PIN (COTTER INCLUDED)	1

ESTIMATED SHIPPING WEIGHT: 40LBS

BARRETO

TITLE: CHAIN, 12' 11 STA 4" COMBOSHARK

PRODUCT LINE: TRENCHERS 912, 712 DATE: 03/21/2014

SCALE: 1:6

DWG# 03611-4MS

SHEET 1 OF 1

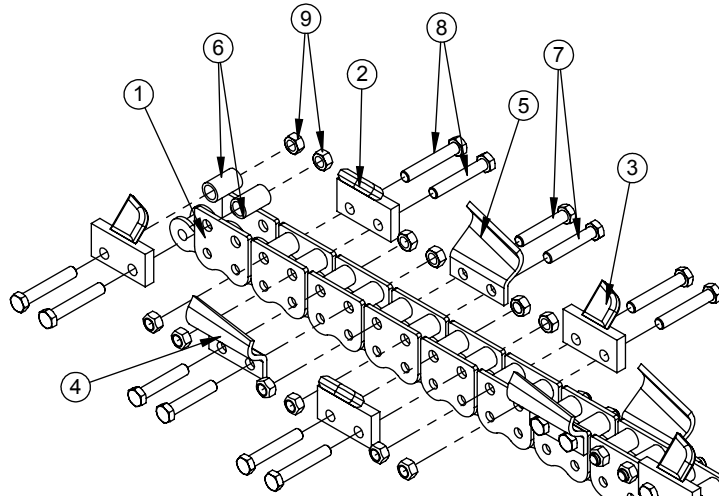

ITEM NO.	PART NUMBER	DESCRIPTION	QTY.
1	03622-B	BARE CHAIN, 44 LINK, 1.25 PITCH	1
2	03632-L	SHARK TOOTH, LEFT, 1.25" P	6
3	03632-R	SHARK TOOTH, RIGHT, 1.25" P	6
4	03630	CUP, LEFT	5
5	03631	CUP, RIGHT	5
6	11008	PLATE SPACER, 1.06"	44
7	11010	HH CAP SCREW, 3/8-24 NF X 2 G8 ZINC	20
8	05281	HH CAP SCREW, 3/8-24 NF X 2-1/4 G8 PLAIN	24
9	05283	NUT, GRIPCO, 3/8-24 NF G8 ZINC	44
10	03519	CONNECTING PIN (COTTER INCLUDED)	1

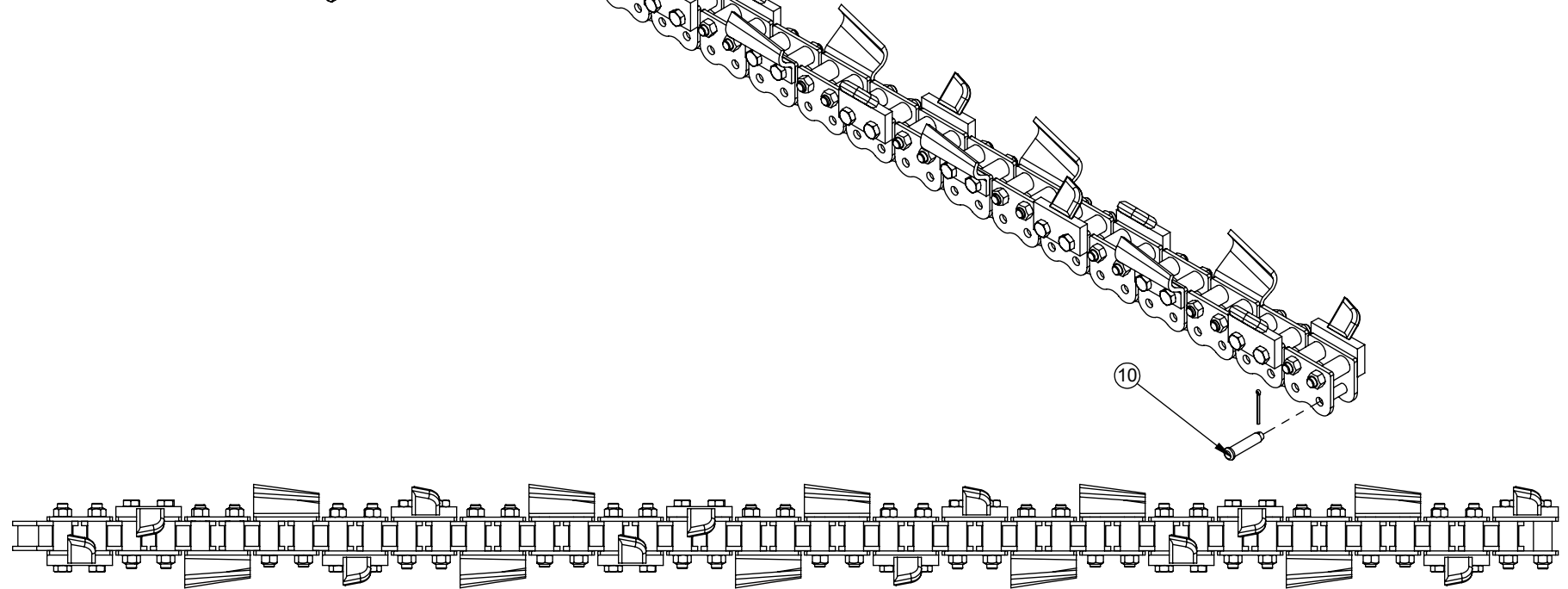

ESTIMATED SHIPPING WEIGHT: 40 LBS

BARRETO

TITLE: CHAIN, 12" 22 STA 4" COMBOSHARK
 PRODUCT LINE: TRENCHERS 912, 712 DATE: 03/18/2014
 SCALE: 1:6 DWG# 03622-4MS
 SHEET 1 OF 1

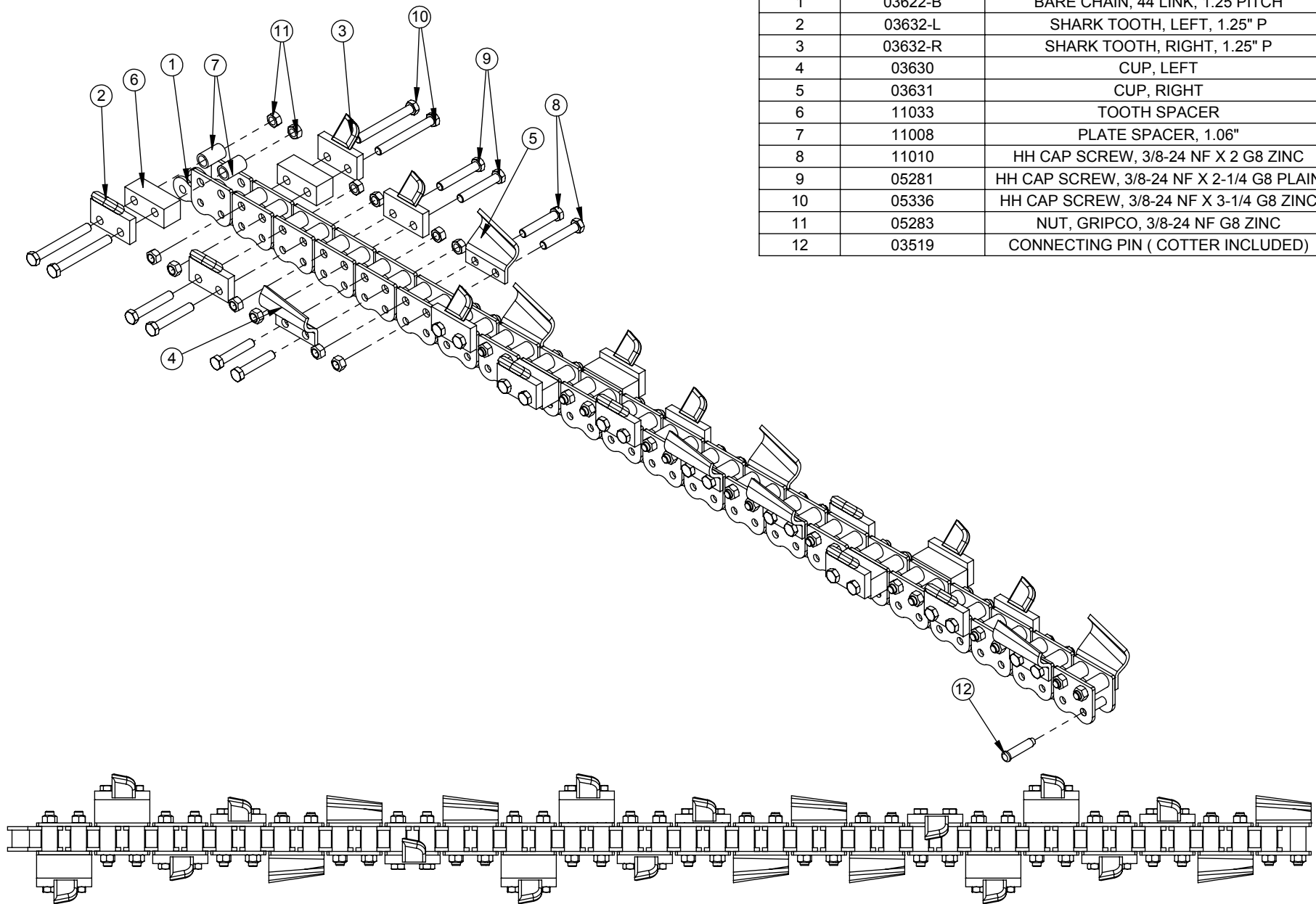

ITEM NO.	PART NUMBER	DESCRIPTION	QTY.
1	03622-B	BARE CHAIN, 44 LINK, 1.25 PITCH	1
2	03632-L	SHARK TOOTH, LEFT, 1.25" P	7
3	03632-R	SHARK TOOTH, RIGHT, 1.25" P	7
4	03630	CUP, LEFT	4
5	03631	CUP, RIGHT	4
6	11033	TOOTH SPACER	6
7	11008	PLATE SPACER, 1.06"	44
8	11010	HH CAP SCREW, 3/8-24 NF X 2 G8 ZINC	16
9	05281	HH CAP SCREW, 3/8-24 NF X 2-1/4 G8 PLAIN	16
10	05336	HH CAP SCREW, 3/8-24 NF X 3-1/4 G8 ZINC	12
11	05283	NUT, GRIPCO, 3/8-24 NF G8 ZINC	44
12	03519	CONNECTING PIN (COTTER INCLUDED)	1

ESTIMATED SHIPPING WEIGHT: 50 LBS

BARRETO

TITLE: CHAIN, 12" 22 STA 6" COMBOSHARK

PRODUCT LINE: TRENCHERS 912, 712 DATE:03/18/2014

SCALE: 1:6 DWG# 03622-6MS

SHEET 1 OF 1

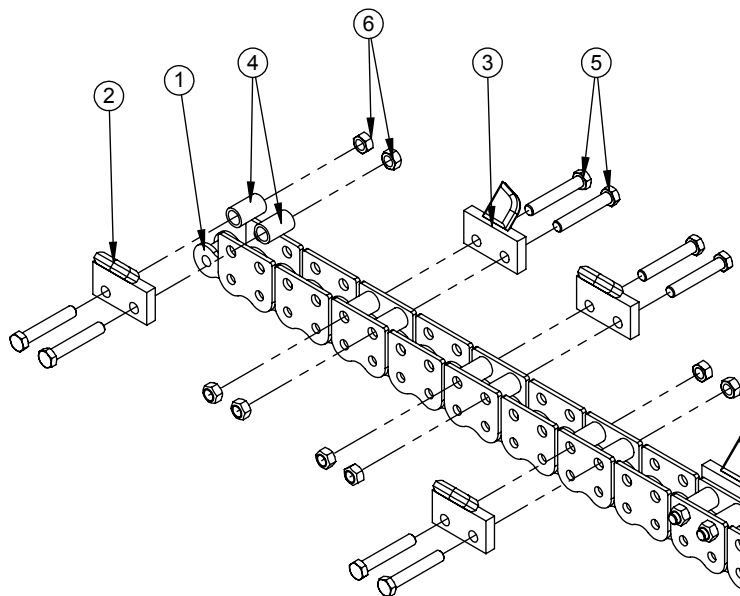

ITEM NO.	PART NUMBER	DESCRIPTION	QTY.
1	03622-B	BARE CHAIN, 44 LINK, 1.25 PITCH	1
2	03632-L	SHARK TOOTH, LEFT, 1.25" P	6
3	03632-R	SHARK TOOTH, RIGHT, 1.25" P	5
4	11008	PLATE SPACER, 1.06"	22
5	05281	HH CAP SCREW, 3/8-24 NF X 2-1/4 G8 PLAIN	22
6	05283	NUT, GRIPCO, 3/8-24 NF G8 ZINC	22
7	03519	CONNECTING PIN (COTTER INCLUDED)	1

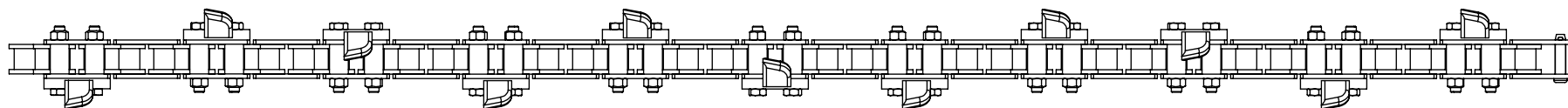
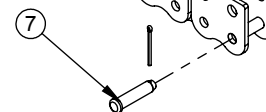

ESTIMATED SHIPPING WEIGHT: 40 LBS

BARRETO

TITLE: CHAIN, 12" 11 STA 4" SHARKBOLT

PRODUCT LINE: TRENCHERS 912, 712 DATE: 03/19/2014

SCALE: 1:6
SHEET 1 OF 1

DWG# 03611-4SB

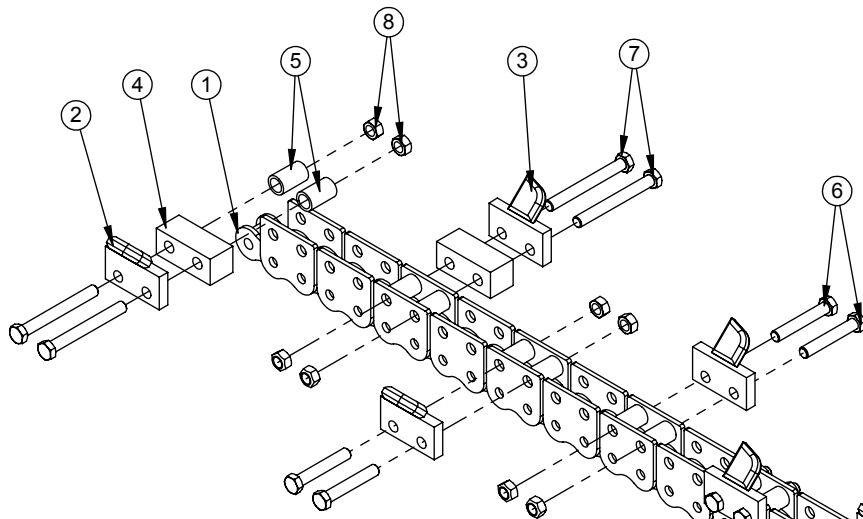

ITEM NO.	PART NUMBER	DESCRIPTION	QTY.
1	03622-B	BARE CHAIN, 44 LINK, 1.25 PITCH	1
2	03632-L	SHARK TOOTH, LEFT, 1.25" P	5
3	03632-R	SHARK TOOTH, RIGHT, 1.25" P	6
4	11033	TOOTH SPACER	4
5	11008	PLATE SPACER, 1.06"	22
6	05281	HH CAP SCREW, 3/8-24 NF X 2-1/4 G8 PLAIN	14
7	05336	HH CAP SCREW, 3/8-24 NF X 3-1/4 G8 ZINC	8
8	05283	NUT, GRIPCO, 3/8-24 NF G8 ZINC	22
9	03519	CONNECTING PIN (COTTER INCLUDED)	1

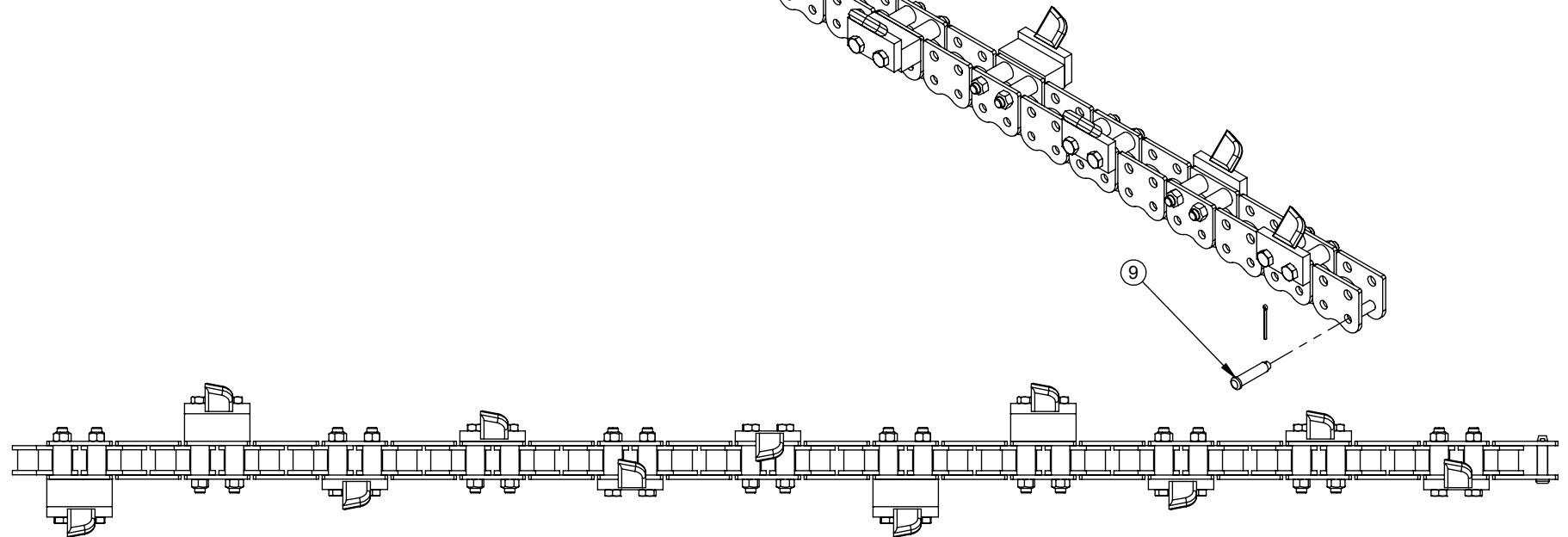

ESTIMATED SHIPPING WEIGHT: 50 LBS

BARRETO	TITLE: CHAIN, 12" 11 STA 6" SHARKBOLT	
	PRODUCT LINE: TRENCHERS 912, 712 DATE: 03/19/2014	
	SCALE: 1:6	DWG# 03611-6SB
	SHEET 1 OF 1	

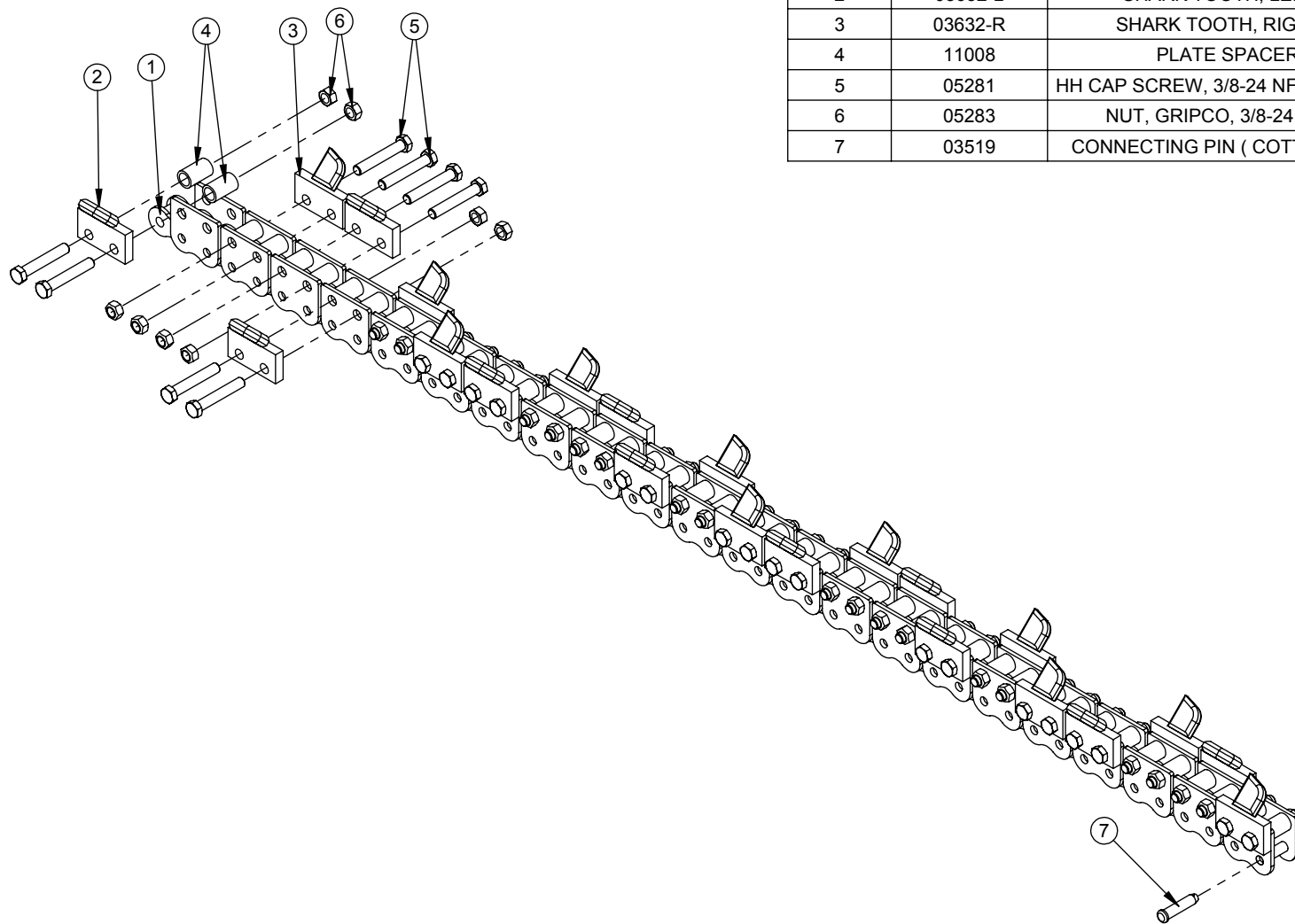

ITEM NO.	PART NUMBER	DESCRIPTION	QTY.
1	03622-B	BARE CHAIN, 44 LINK, 1.25 PITCH	1
2	03632-L	SHARK TOOTH, LEFT, 1.25" P	11
3	03632-R	SHARK TOOTH, RIGHT, 1.25" P	11
4	11008	PLATE SPACER, 1.06"	44
5	05281	HH CAP SCREW, 3/8-24 NF X 2-1/4 G8 PLAIN	44
6	05283	NUT, GRIPCO, 3/8-24 NF G8 ZINC	44
7	03519	CONNECTING PIN (COTTER INCLUDED)	1

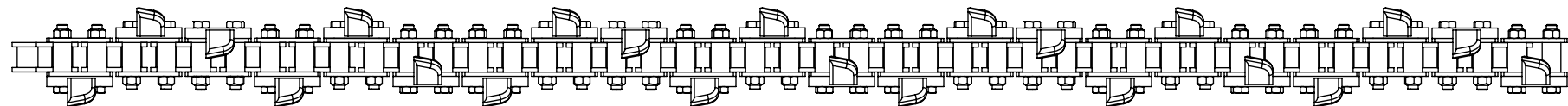

ESTIMATED SHIPPING WEIGHT: 40 LBS

BARRETO

TITLE: CHAIN, 12" 22 STA 4" SHARKBOLT
 PRODUCT LINE: TRENCHERS 912, 712 DATE: 03/18/2014
 SCALE: 1:6
 SHEET 1 OF 1 DWG# 03622-4SB

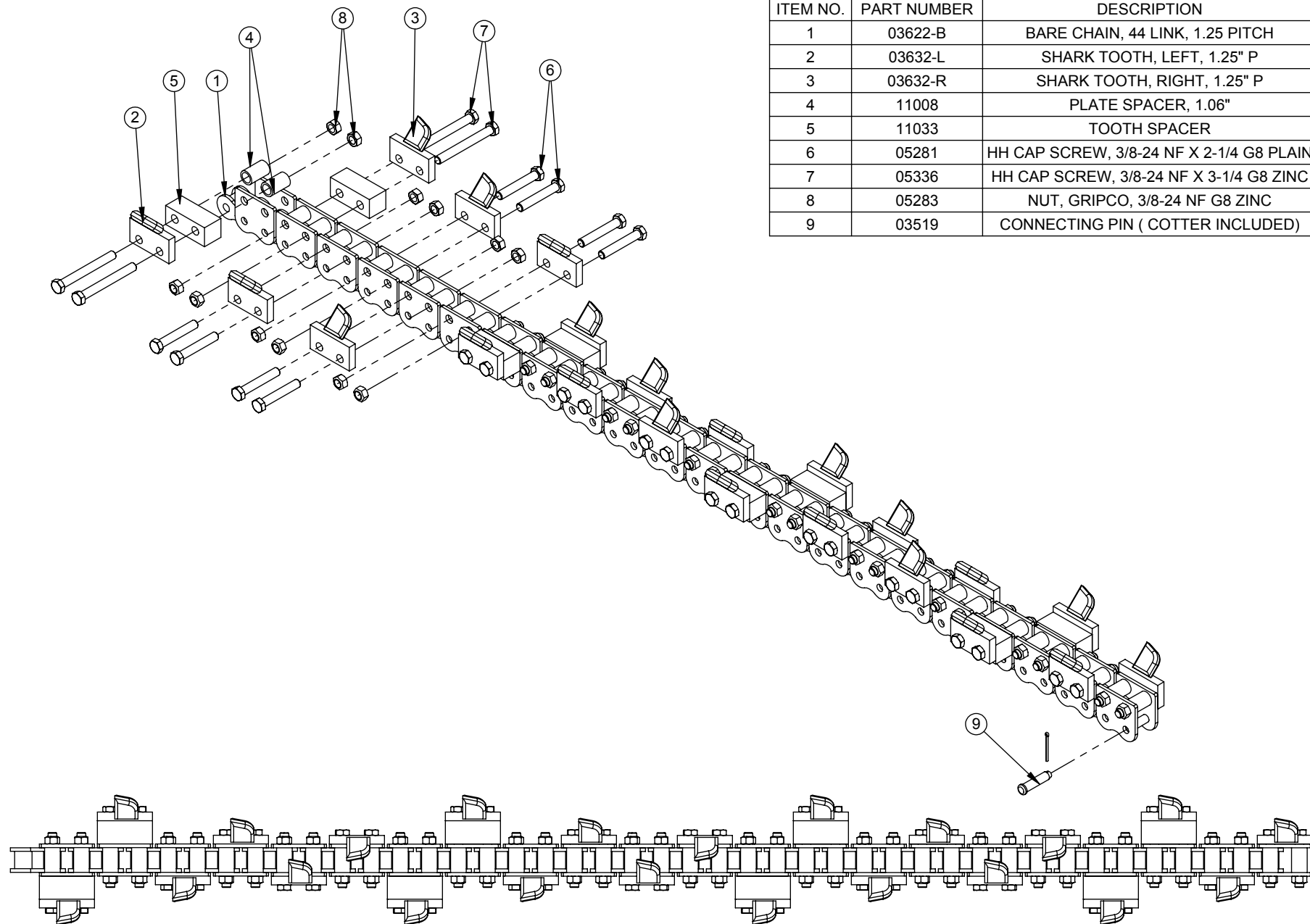

ITEM NO.	PART NUMBER	DESCRIPTION	QTY.
1	03622-B	BARE CHAIN, 44 LINK, 1.25 PITCH	1
2	03632-L	SHARK TOOTH, LEFT, 1.25" P	11
3	03632-R	SHARK TOOTH, RIGHT, 1.25" P	11
4	11008	PLATE SPACER, 1.06"	44
5	11033	TOOTH SPACER	8
6	05281	HH CAP SCREW, 3/8-24 NF X 2-1/4 G8 PLAIN	28
7	05336	HH CAP SCREW, 3/8-24 NF X 3-1/4 G8 ZINC	16
8	05283	NUT, GRIPCO, 3/8-24 NF G8 ZINC	44
9	03519	CONNECTING PIN (COTTER INCLUDED)	1

ESTIMATED SHIPPING WEIGHT: 50 LBS

BARRETO

TITLE: CHAIN, 12" 22 STA 6" SHARKBOLT

PRODUCT LINE: TRENCHERS 912, 712 DATE: 03/18/2014

SCALE: 1:6
SHEET 1 OF 1

DWG# 03622-6SB