

ITEM NO.	PART NUMBER	DESCRIPTION	QTY.
1	03626-B	BARE CHAIN, 26 STATION, 1.25 PITCH	1
2	03519	CONNECTING PIN (COTTER INCLUDED)	1

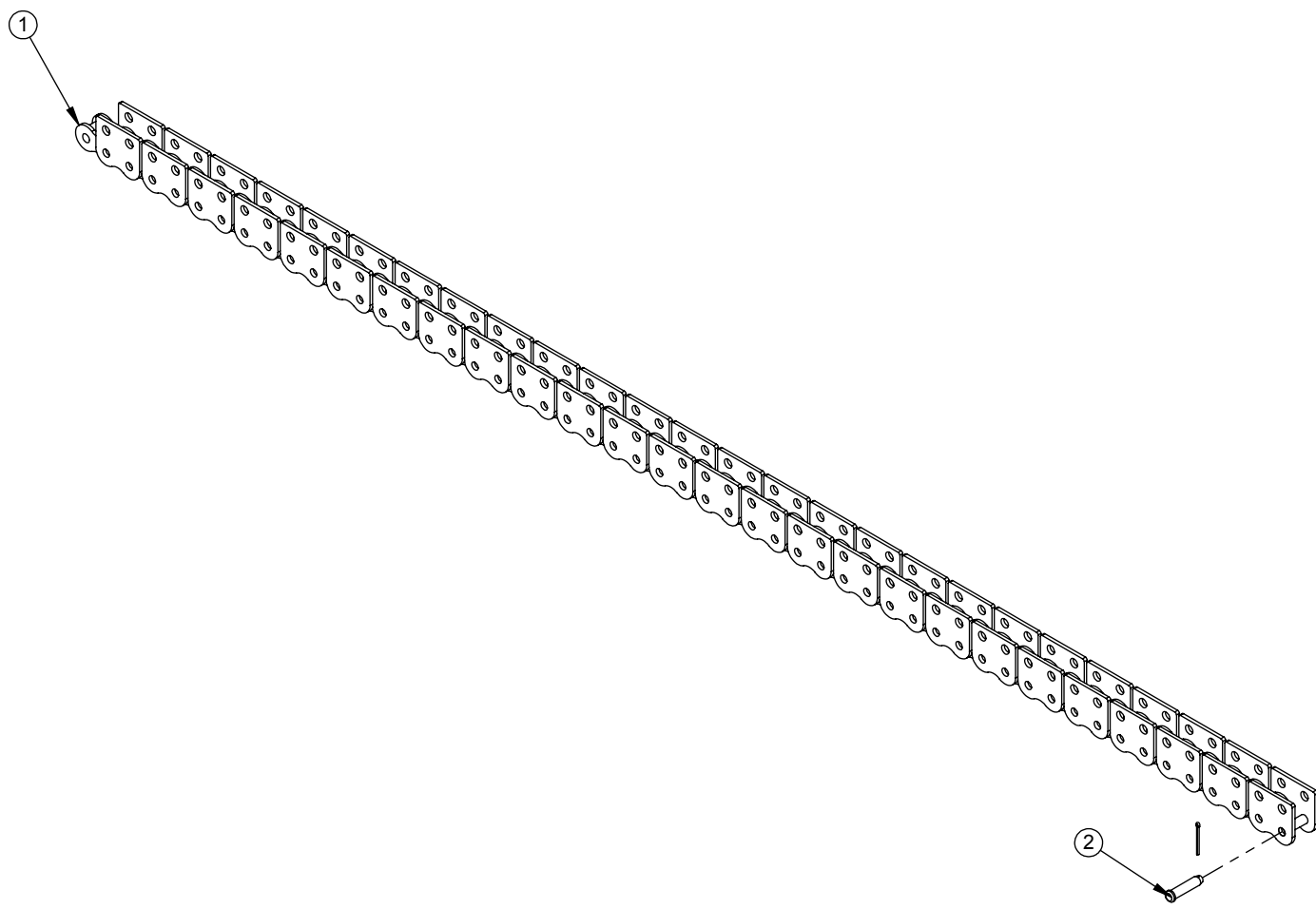

ESTIMATED SHIPPING WEIGHT: 35LBS

BARRETO	TITLE: BARE CHAIN, 52 LINK, 1.25 PITCH	
	PRODUCT LINE: TRENCHERS 712, 912 DATE: 03/20/2014	
	SCALE: 1:7	DWG# 03626-B
	SHEET 1 OF 1	

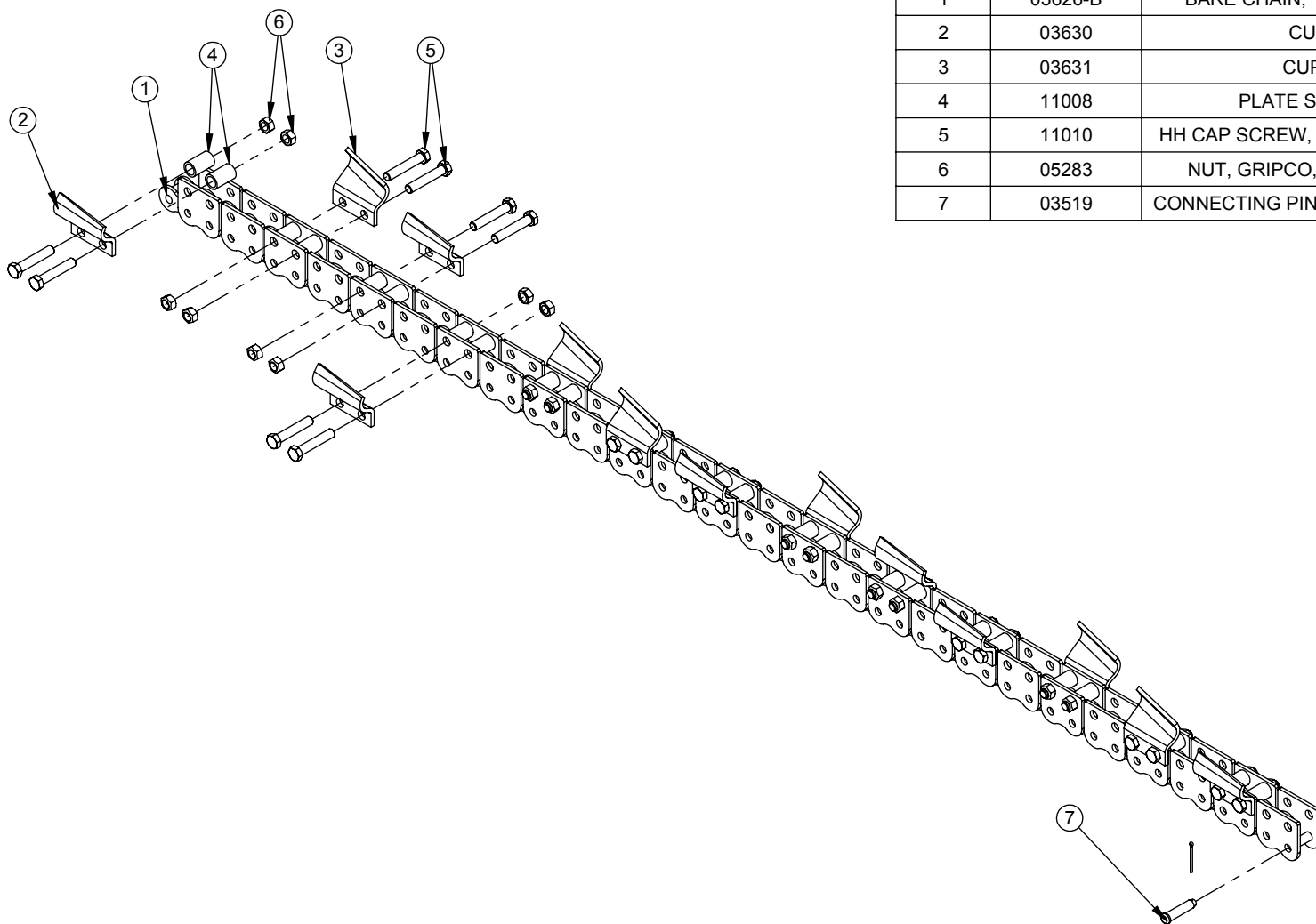

ITEM NO.	PART NUMBER	DESCRIPTION	QTY.
1	03626-B	BARE CHAIN, 1.25 PITCH, 52 LINK	1
2	03630	CUP, LEFT	7
3	03631	CUP, RIGHT	6
4	11008	PLATE SPACER, 1.06"	26
5	11010	HH CAP SCREW, 3/8-24 NF X 2 G8 ZINC	26
6	05283	NUT, GRIPCO, 3/8-24 NF G8 ZINC	26
7	03519	CONNECTING PIN (COTTER INCLUDED)	1

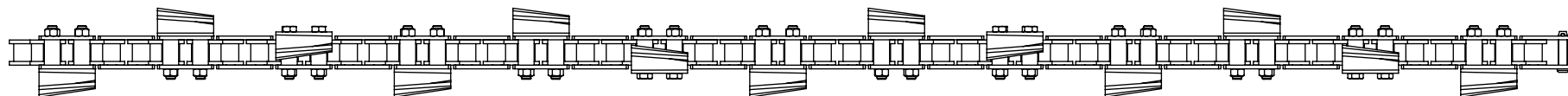

ESTIMATED SHIPPING WEIGHT: 40LBS

BARRETO

TITLE: CHAIN, 18" 13 STA 4" CUP

PRODUCT LINE: TRENCHERS 912, 712 DATE: 03/20/2018

SCALE: 1:7
SHEET 1 OF 1

DWG# 03613-4C

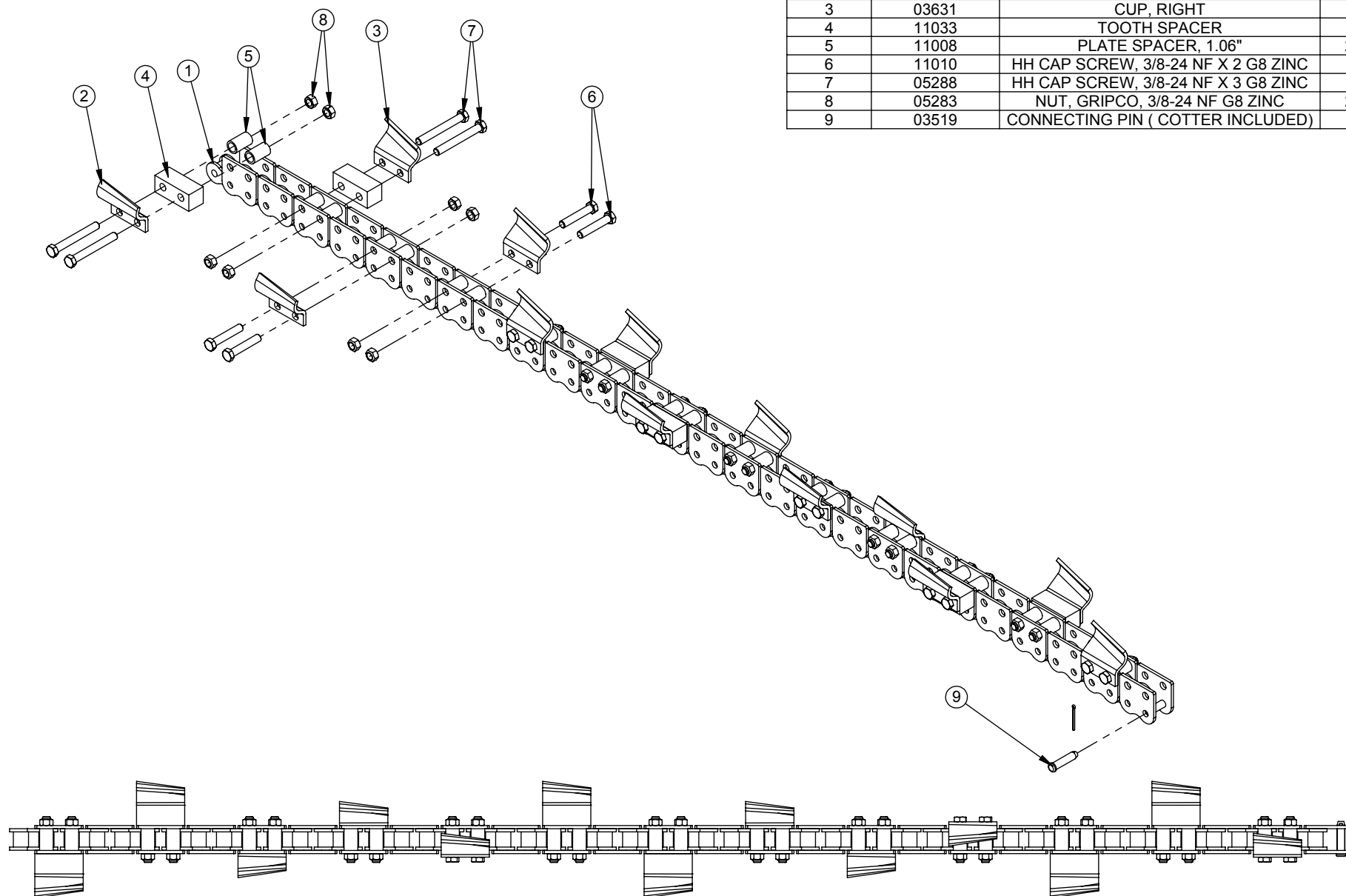

ITEM NO.	PART NUMBER	DESCRIPTION	QTY.
1	03626-B	BARE CHAIN, 1.25 PITCH, 52 LINK	1
2	03630	CUP, LEFT	6
3	03631	CUP, RIGHT	7
4	11033	TOOTH SPACER	6
5	11008	PLATE SPACER, 1.06"	26
6	11010	HH CAP SCREW, 3/8-24 NF X 2 G8 ZINC	14
7	05288	HH CAP SCREW, 3/8-24 NF X 3 G8 ZINC	12
8	05283	NUT, GRIPCO, 3/8-24 NF G8 ZINC	26
9	03519	CONNECTING PIN (COTTER INCLUDED)	1

ESTIMATED SHIPPING WEIGHT: 50LBS

BARRETO

TITLE: CHAIN, 18" 13 STA 6" CUP

PRODUCT LINE: TRENCHERS 912, 712 DATE: 03/20/2014

SCALE: 1:7
SHEET 1 OF 1

DWG# 03613-6C

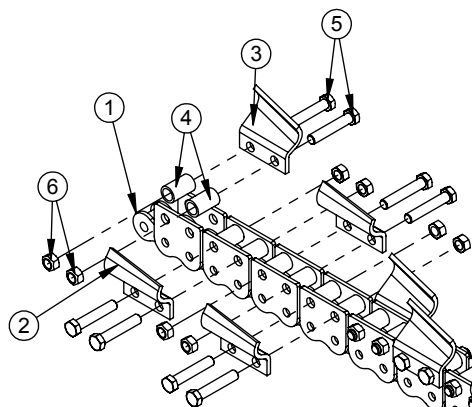

ITEM NO.	PART NUMBER	DESCRIPTION	QTY.
1	03626-B	BARE CHAIN, 52 LINK 1.25 PITCH	1
2	03630	CUP, LEFT	13
3	03631	CUP, RIGHT	13
4	11008	PLATE SPACER, 1.06"	52
5	11010	HH CAP SCREW, 3/8-24 NF X 2 G8 ZINC	52
6	05283	NUT, GRIPCO, 3/8-24 NF G8 ZINC	52
7	03519	CONNECTING PIN (COTTER INCLUDED)	1

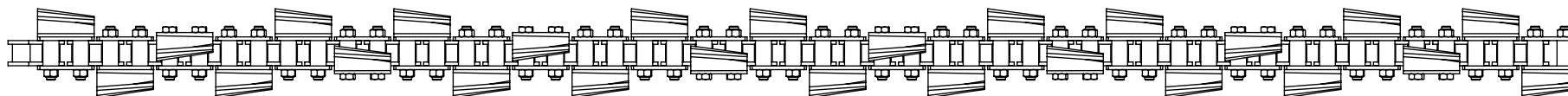
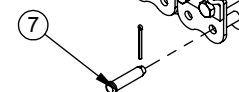

ESTIMATED SHIPPIING WEIGHT: 40 LBS

BARRETO

TITLE: CHAIN, 18" 26 STA 4" CUP

PRODUCT LINE:TRENCHERS 912, 712 DATE: 04/03/2014

SCALE: 1:7

SHEET 1 OF 1

DWG# 03626-4C

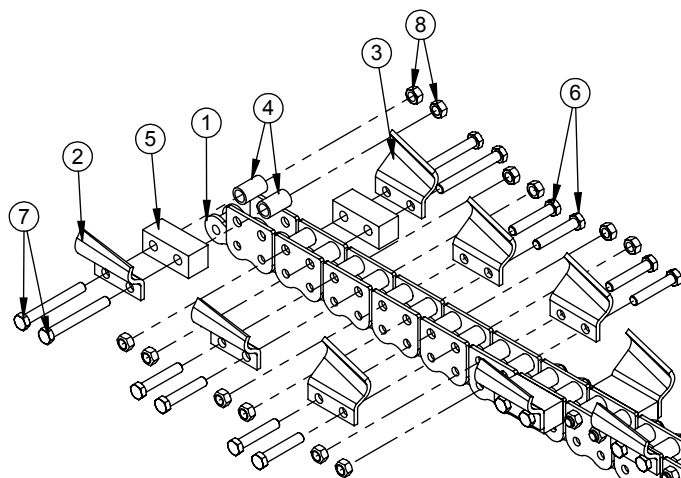

ITEM NO.	PART NUMBER	DESCRIPTION	QTY.
1	03626-B	BARE CHAIN, 52 LINK, 1.25 PITCH	1
2	03630	CUP, LEFT	13
3	03631	CUP, RIGHT	13
4	11008	PLATE SPACER, 1.06"	52
5	11033	TOOTH SPACER	8
6	11010	HH CAP SCREW, 3/8-24 NF X 2 G8 ZINC	36
7	05288	HH CAP SCREW, 3/8-24 NF X 3 G8 ZINC	16
8	05283	NUT, GRIPCO, 3/8-24 NF G8 ZINC	52
9	03519	CONNECTING PIN (COTTER INCLUDED)	1

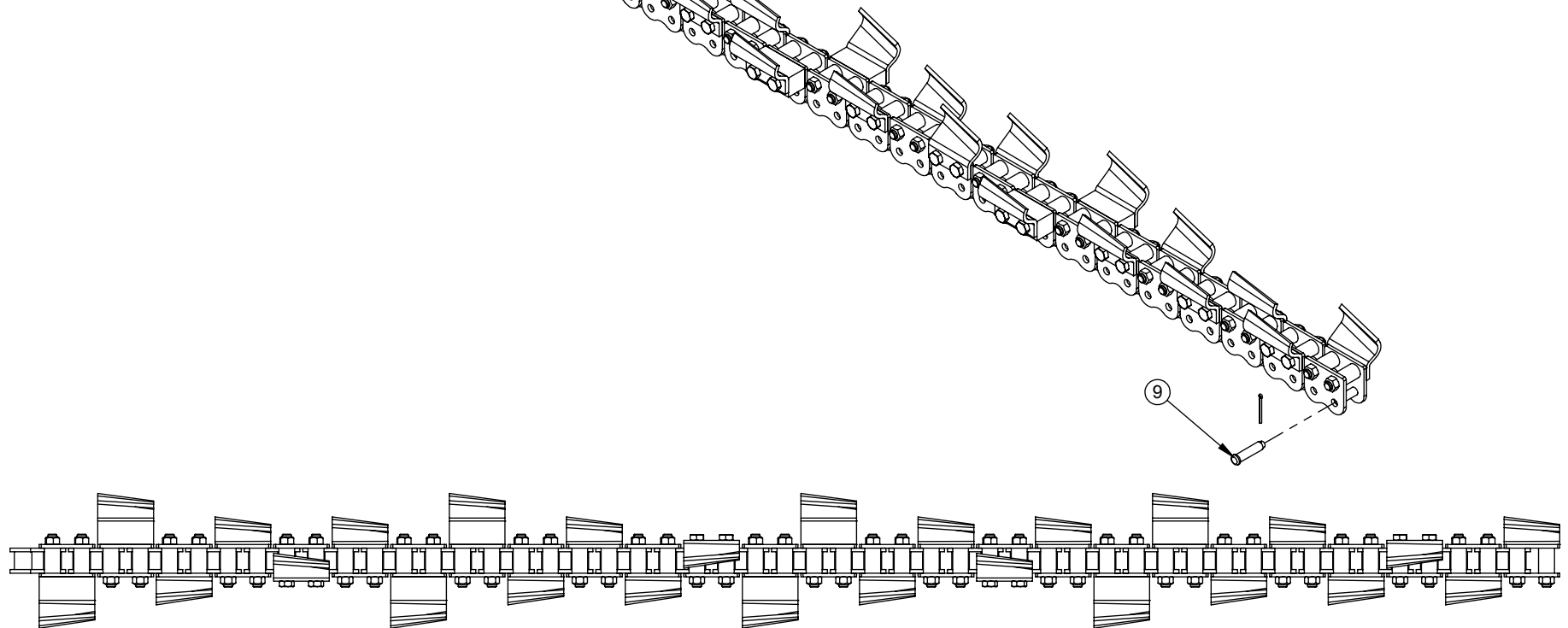

ESTIMATED SHIPPPING WEIGHT: 50 LBS

BARRETO

TITLE: CHAIN, 18" 26 STA 6" CUP

PRODUCT LINE: TRENCHERS 912, 712 DATE: 04/03/2014

SCALE: 1:7
SHEET 1 OF 1

DWG# 03626-6C

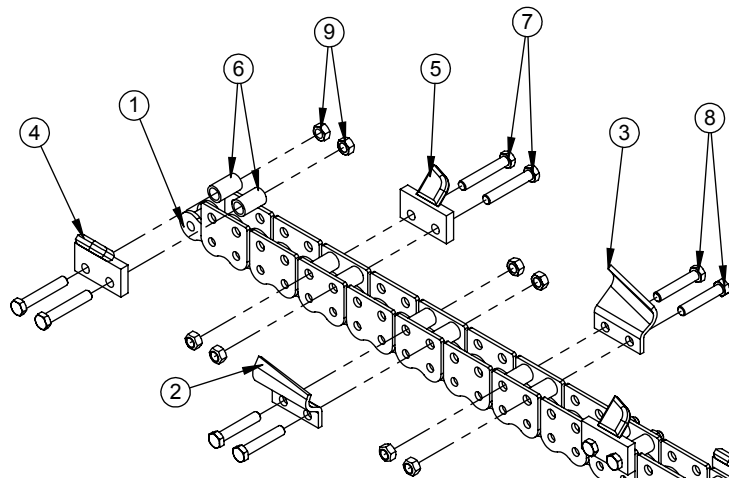

ITEM NO.	PART NUMBER	DESCRIPTION	QTY.
1	03626-B	BARE CHAIN, 1.25 PITCH, 52 LINK	1
2	03630	CUP, LEFT	3
3	03631	CUP, RIGHT	3
4	03632-L	SHARK TOOTH, LEFT, 1.25" P	4
5	03632-R	SHARK TOOTH, RIGHT, 1.25" P	3
6	11008	PLATE SPACER, 1.06"	26
7	05281	HH CAP SCREW, 3/8-24 NF X 2-1/4 G8 PLAIN	14
8	11010	HH CAP SCREW, 3/8-24 NF X 2 G8 ZINC	12
9	05283	NUT, GRIPCO, 3/8-24 NF G8 ZINC	26
10	03519	CONNECTING PIN (COTTER INCLUDED)	1

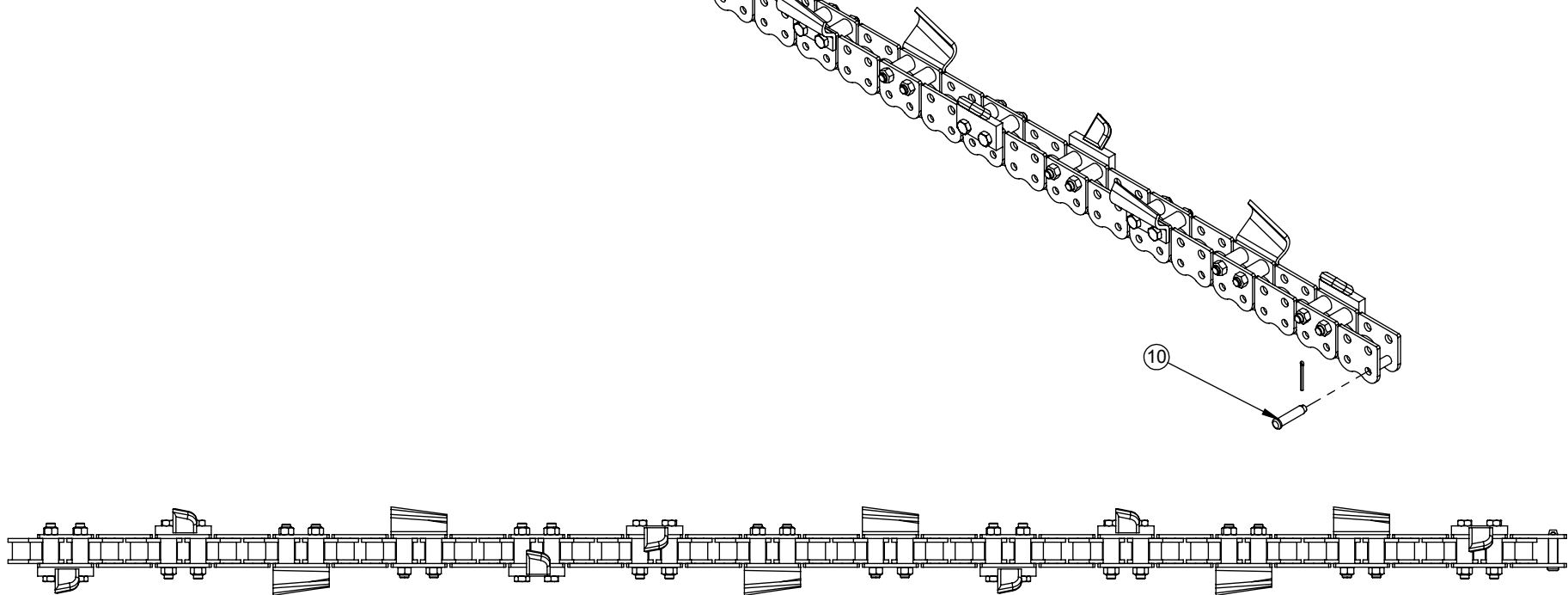

ESTIMATED SHIPPING WEIGHT: 40 LBS

BARRETO

TITLE: CHAIN, 18" 13 STA 4" COMBOSHARK

PRODUCT LINE: TRENCHERS 912, 712 DATE: 03/20/2014

SCALE: 1:7 DWG# 03613-4MS

SHEET 1 OF 1

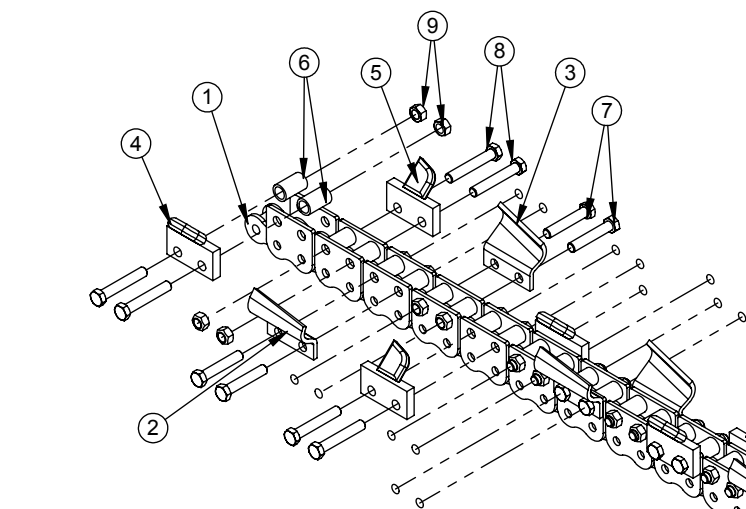

ITEM NO.	PART NUMBER	DESCRIPTION	QTY.
1	03626-B	BARE CHAIN, 52 LINK, 1.25 PITCH	1
2	03630	CUP, LEFT	6
3	03631	CUP, RIGHT	6
4	03632-L	SHARK TOOTH, LEFT, 1.25" P	7
5	03632-R	SHARK TOOTH, RIGHT, 1.25" P	7
6	11008	PLATE SPACER, 1.06"	52
7	11010	HH CAP SCREW, 3/8-24 NF X 2 G8 ZINC	24
8	05281	HH CAP SCREW, 3/8-24 NF X 2-1/4 G8 PLAIN	28
9	05283	NUT, GRIPCO, 3/8-24 NF G8 ZINC	52
10	03519	CONNECTING PIN (COTTER INCLUDED)	1

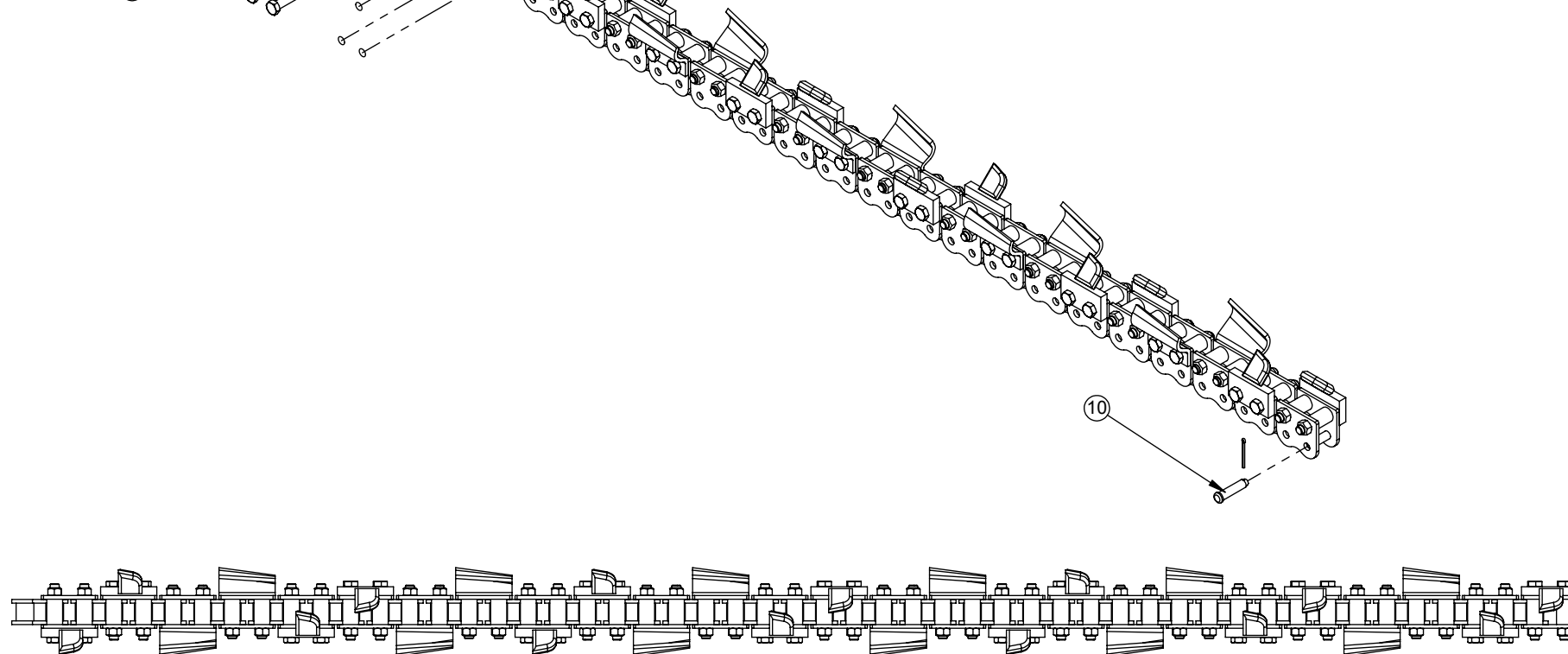

ESTIMATED SHIPPING WEIGHT: 40 LBS

BARRETO

TITLE: CHAIN, 18" 26 STA 4" COMBOSHARK
 PRODUCT LINE: TRENCHERS 912, 712 DATE: 03/20/2014
 SCALE: 1:7
 SHEET 1 OF 1 DWG# 03626-4MS

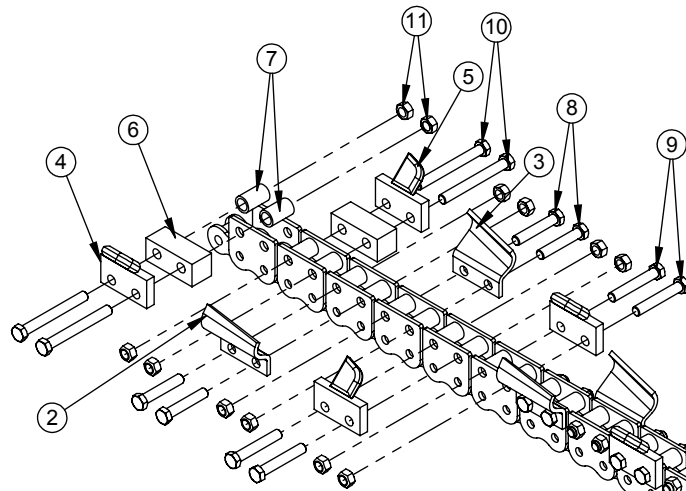

ITEM NO.	PART NUMBER	DESCRIPTION	QTY.
1	03626-B	BARE CHAIN, 52 LINK, 1.25 PITCH	1
2	03630	CUP, LEFT	6
3	03631	CUP, RIGHT	6
4	03632-L	SHARK TOOTH, LEFT, 1.25" P	7
5	03632-R	SHARK TOOTH, RIGHT, 1.25" P	7
6	11033	TOOTH SPACER	6
7	11008	PLATE SPACER, 1.06"	52
8	11010	HH CAP SCREW, 3/8-24 NF X 2 G8 ZINC	24
9	05281	HH CAP SCREW, 3/8-24 NF X 2-1/4 G8 PLAIN	16
10	05336	HH CAP SCREW, 3/8-24 NF X 3-1/4 G8 ZINC	12
11	05283	NUT, GRIPCO, 3/8-24 NF G8 ZINC	52
12	03519	CONNECTING PIN (COTTER INCLUDED)	1

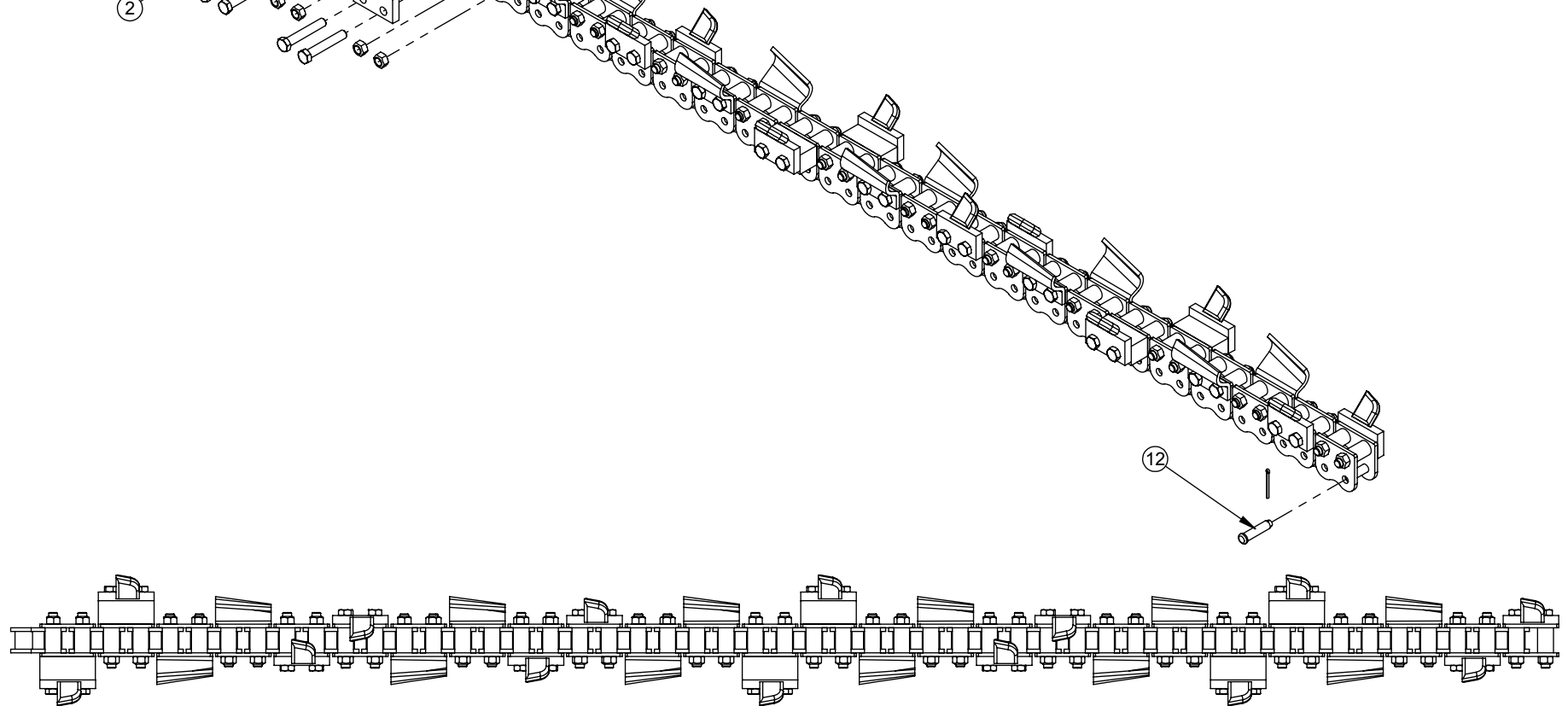

ESTIMATED SHIPPING WEIGHT: 50 LBS

BARRETO

TITLE: CHAIN, 18" 26 STA 6" COMBOSHARK

PRODUCT LINE: TRENCHERS 912, 712 DATE: 03/20/2014

SCALE: 1:7

SHEET 1 OF 1 DWG# 03626-6MS

ITEM NO.	PART NUMBER	DESCRIPTION	QTY.
1	03626-B	BARE CHAIN, 1.25 PITCH, 52 LINK	1
2	03632-L	SHARK TOOTH, LEFT, 1.25" P	7
3	03632-R	SHARK TOOTH, RIGHT, 1.25" P	6
4	11008	PLATE SPACER, 1.06"	26
5	05281	HH CAP SCREW, 3/8-24 NF X 2-1/4 G8 PLAIN	26
6	05283	NUT, GRIPCO, 3/8-24 NF G8 ZINC	26
7	03519	CONNECTING PIN (COTTER INCLUDED)	1

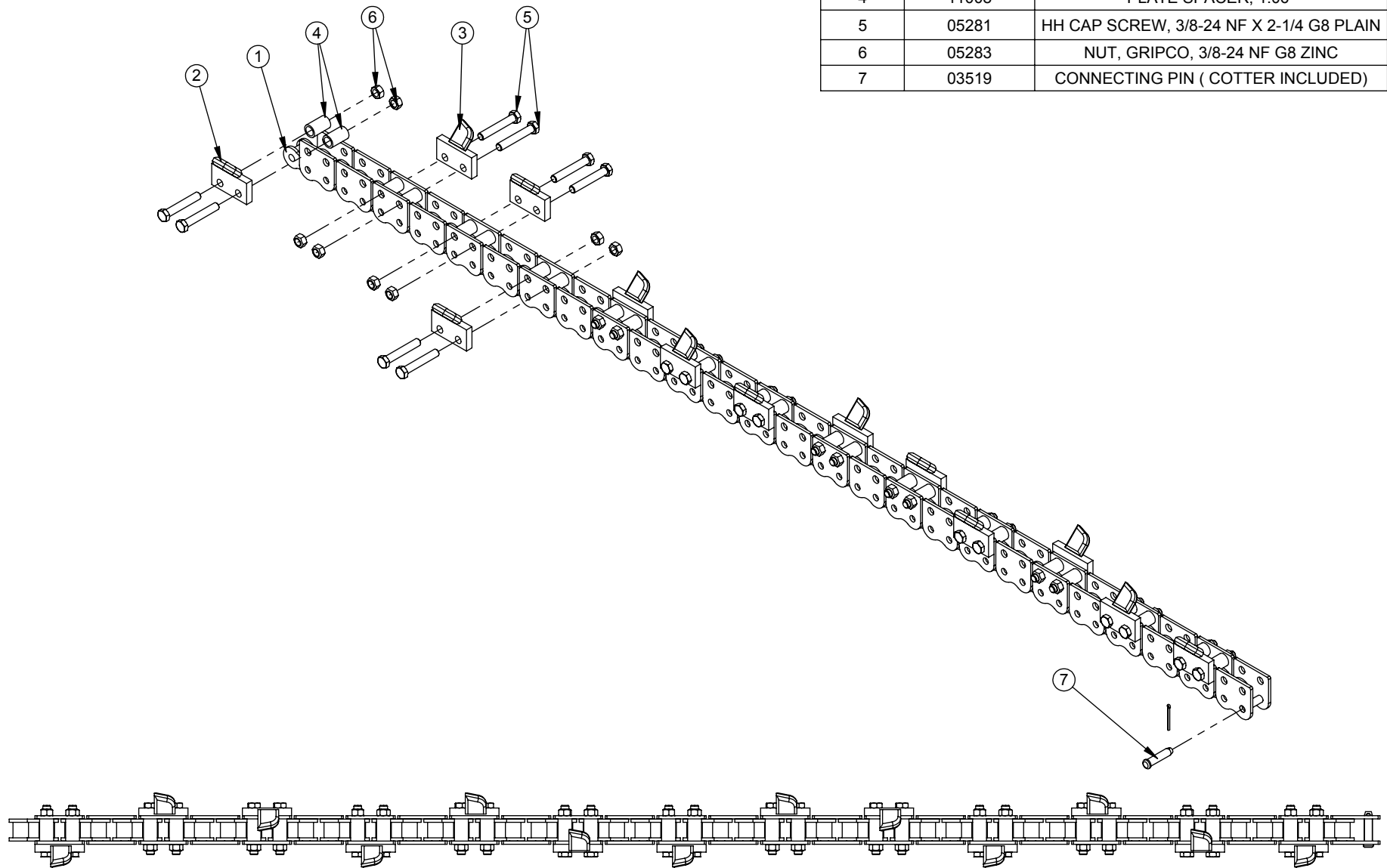

ESTIMATED SHIPPING WEIGHT: 40LBS

BARRETO	TITLE: CHAIN, 18" 13 STA 4" SHARKBOLT	
	PRODUCT LINE: TRENCHERS 912, 712	DATE: 03/20/2014
	SCALE: 1:7	DWG# 03613-4SB
	SHEET 1 OF 1	

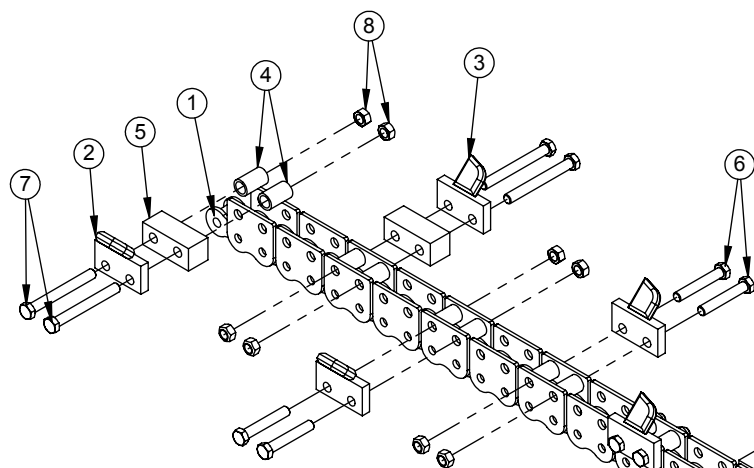

ITEM NO.	PART NUMBER	DESCRIPTION	QTY.
1	03626-B	BARE CHAIN, 52 LINK, 1.25 PITCH	1
2	03632-L	SHARK TOOTH, LEFT, 1.25" P	6
3	03632-R	SHARK TOOTH, RIGHT, 1.25" P	7
4	11008	PLATE SPACER, 1.06"	26
5	11033	TOOTH SPACER	6
6	05281	HH CAP SCREW, 3/8-24 NF X 2-1/4 G8 PLAIN	14
7	05336	HH CAP SCREW, 3/8-24 NF X 3-1/4 G8 ZINC	12
8	05283	NUT, GRIPCO, 3/8-24 NF G8 ZINC	26
9	03519	CONNECTING PIN (COTTER INCLUDED)	1

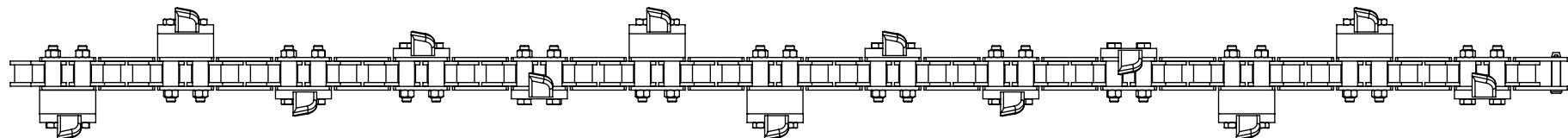

ESTIMATED SHIPPING WEIGHT: 50 LBS

BARRETO

TITLE: CHAIN, 18" 13 STA 6" SHARKBOLT

PRODUCT LINE: TRENCHERS 712, 912 DATE: 04/10/2014

SCALE: 1:7
SHEET 1 OF 1

DWG# 03613-6SB

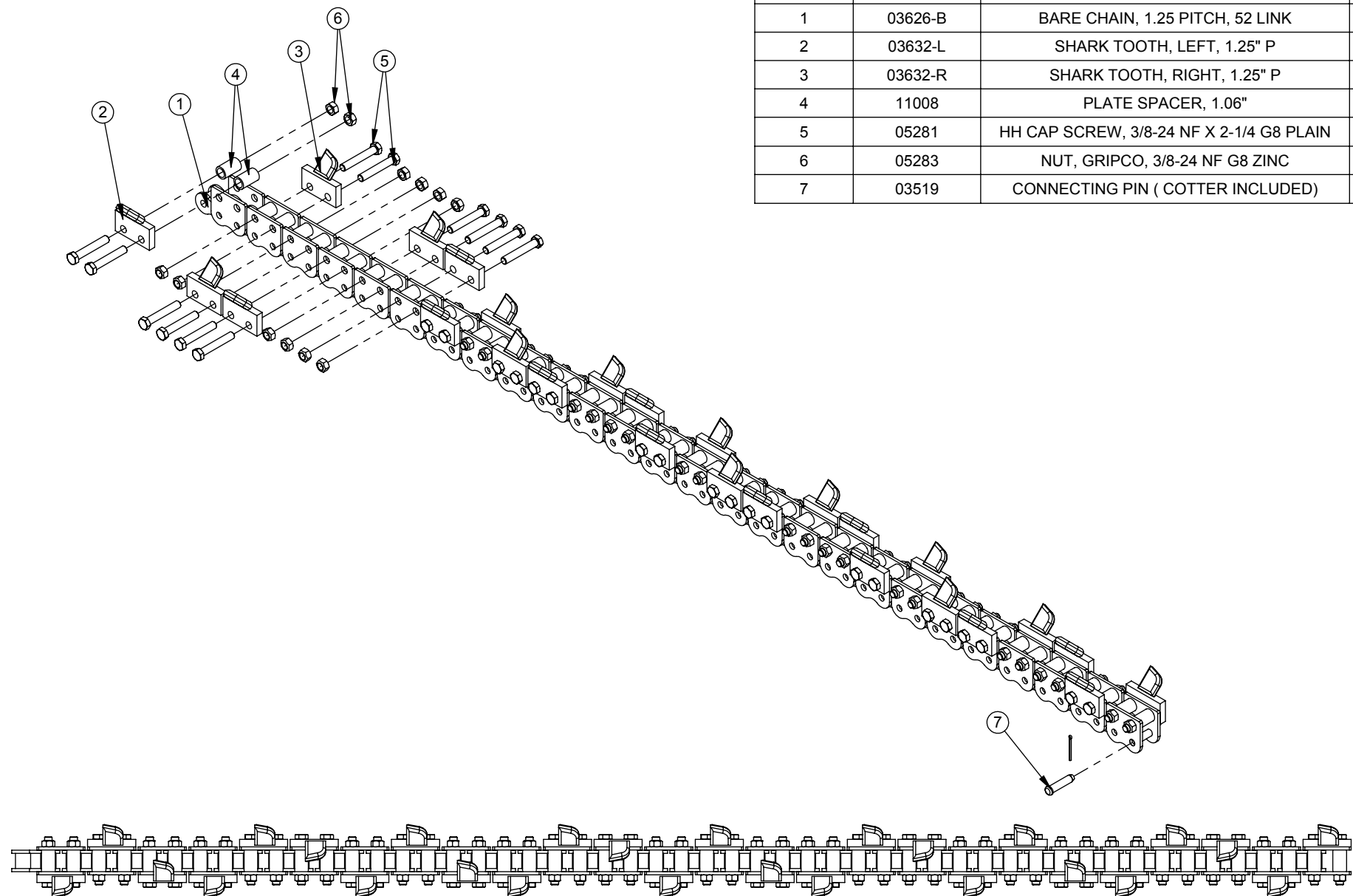

ITEM NO.	PART NUMBER	DESCRIPTION	QTY.
1	03626-B	BARE CHAIN, 1.25 PITCH, 52 LINK	1
2	03632-L	SHARK TOOTH, LEFT, 1.25" P	13
3	03632-R	SHARK TOOTH, RIGHT, 1.25" P	13
4	11008	PLATE SPACER, 1.06"	52
5	05281	HH CAP SCREW, 3/8-24 NF X 2-1/4 G8 PLAIN	52
6	05283	NUT, GRIPCO, 3/8-24 NF G8 ZINC	52
7	03519	CONNECTING PIN (COTTER INCLUDED)	1

ESTIMATED SHIPPING WEIGHT: 40 LBS

BARRETO

TITLE: CHAIN, 18" 26 STA 4" SHARKBOLT

PRODUCT LINE: TRENCHERS 912, 712 DATE: 03/20/2014

SCALE: 1:7
SHEET 1 OF 1

DWG# 03626-4SB



712/912 TRENCHER CHAIN TYPES / DESCRIPTIONS

STANDARD CUP CHAIN (AKA Skip Tooth)

This chain has a cup tooth on every other link.

Where to use it

This chain is most effective in loamy soil - soil that is packable into clods. It is also more effective in clay or "gumbo" soil that is sticky and clings to the chain. The space between the cups allows the soil to let go instead of running around with the chain as a slurry which prevents effective digging.



DOUBLE CUP CHAIN

This chain has a cup tooth on every link.

Where to use it

This chain is best for sand and dry, loose soil that has a tendency to fall back into the trench. The extra cups provide for better clean-out.



COMBO/SHARK CHAIN

This chain has an alternating pattern of cup and Shark teeth.

Where to use it.

It is designed for areas that have variable soil types. The shark teeth are effective in rocky soil or hard-pan while the cups provide for efficient clean-out. This is our most popular chain.



SHARK CHAIN

The teeth on this chain are all Shark teeth that are welded onto the chain. Replacement teeth are not available for this chain.

Where to use it.

This chain can be used in the most adverse soils. It is good in rocky soil, "cliché", limestone, hard-pan and any other hard to dig soils. It does not clean out well in sandy or dry, loose, loamy soil. This is not the fastest but it is the most durable chain available. It is not uncommon for the teeth to outlast the chain rollers. When the rollers wear out, the complete chain must be replaced.



BOLT-ON SHARK CHAIN

This chain utilizes a standard chain blank and has Shark teeth that are bolted to the chain blank.

Where to use it.

This chain is good in all the conditions described for the Shark chain. The advantage is the teeth can be removed when the chain wears out and can be used on a new blank. It is not uncommon for the teeth to last through two chains.



NOTE: The 712 trencher chains are available in 12" & 18" lengths and 4" & 5" widths. The 912 chains are available in 12", 18", & 24" lengths and 4" & 6" widths.

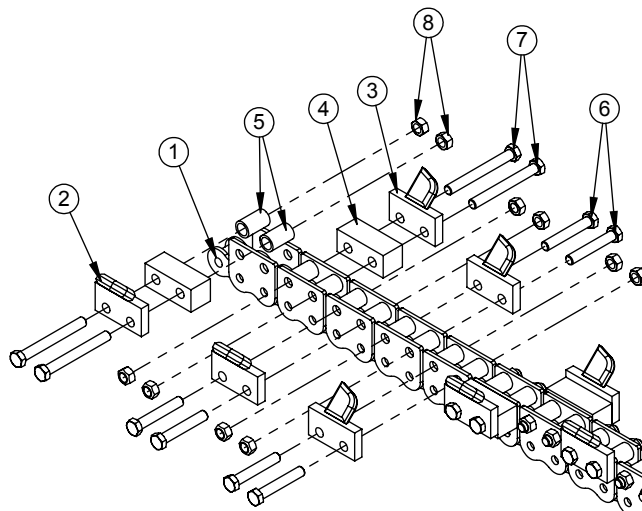

ITEM NO.	PART NUMBER	DESCRIPTION	QTY.
1	03626-B	BARE CHAIN, 1.25 PITCH, 52 LINK	1
2	03632-L	SHARK TOOTH, LEFT, 1.25" P	13
3	03632-R	SHARK TOOTH, RIGHT, 1.25" P	13
4	11033	TOOTH SPACER	10
5	11008	PLATE SPACER, 1.06"	52
6	05281	HH CAP SCREW, 3/8-24 NF X 2-1/4 G8 PLAIN	32
7	05336	HH CAP SCREW, 3/8-24 NF X 3-1/4 G8 ZINC	20
8	05283	NUT, GRIPCO, 3/8-24 NF G8 ZINC	52
9	03519	CONNECTING PIN (COTTER INCLUDED)	1

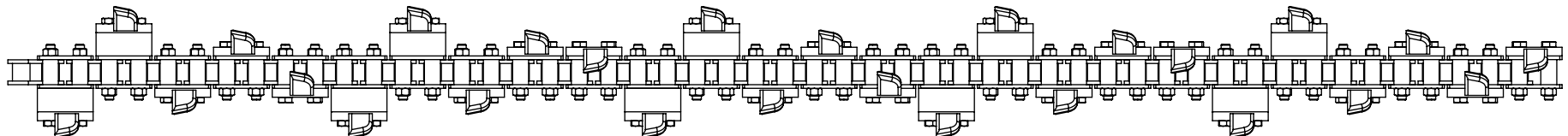
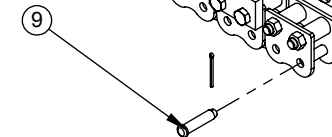

ESTIMATED SHIPPING WEIGHT: 50 LBS

BARRETO

TITLE: CHAIN, 18" 26 STA 6" SHARKBOLT

PRODUCT LINE: TRENCHERS 912, 712 DATE: 03/20/2014

SCALE: 1:7
SHEET 1 OF 1

DWG# 03626-6SB